

ACCESSORIES

BSG PNEUMATIC ACCESSORIES

• PUSH-IN & STANDARD FITTINGS •

• AIR TREATMENT UNITS •

• VALVES AND ACCESSORIES •

• TUBING •

The components illustrated and described in the present catalogue are sold under the trademark BSG Kuhnke Solutions.

BSG Kuhnke Solutions reserves the right to modify the dimensions or technical characteristics of any of its products contained within this catalogue without prior notice. The products included in this catalogue should only be used in applications for which they were originally intended and should only be used by personnel with adequate technical knowledge. Please note that the misuse of this product could cause serious injury. The user should ensure that the product is installed and operated within the operating characteristics shown and that this complies with any health and safety requirements, however should you require any further information please do not hesitate to contact our technical office.

BSG Kuhnke Solutions accepts no liability for damage or injury arising from the error, misuse or omission in the data provided. BSG Kuhnke Solutions accepts no liability from third parties in the form of consequential losses. It is the responsibility and duty of the client/user to ensure that all operating requirements are carried out and that the products are used safely. The application is always under the responsibility of the client/user.

BSG PNEUMATIC ACCESSORIES PUSH-IN & STANDARD FITTINGS

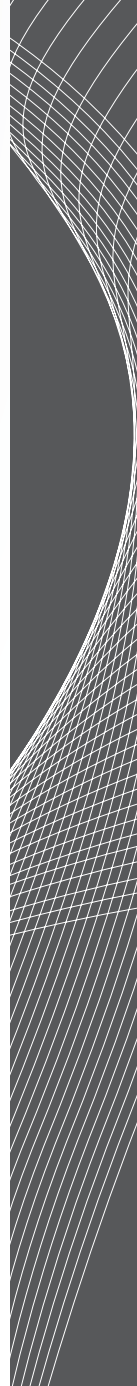

PUSH-IN & STANDARD FITTINGS

Push-in Fittings - General Information

Min. Pressure available:	-0.99 bar
Max. Pressure available:	+15 bar
Plastic tubes:	Nylon PA6; Rilsan PA11; Rilsan PA12; Polyethylene; Polyurethane (98 sh)
Ambient temperature range:	From -20 °C to +80 °C
Compatible medium:	Compressed air
Threads:	Parallel gas (in conformity with ISO 228 Class A) Metric (in conformity with ISO R/262)

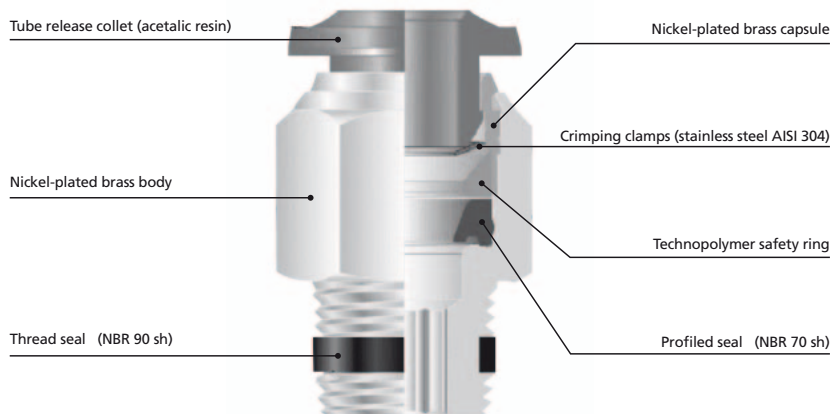

Standard Fittings - General Information

Max. Pressure available:	+60 bar
Body materials:	Nickel-plated brass
Threads:	Tapered gas (in conformity with ISO 7 - DIN 2999 - BS 21) Parallel gas (in conformity with ISO 228 Class A) Metric (in conformity with ISO R/262)

Straight Male Adaptor - Parallel (series 50020N)

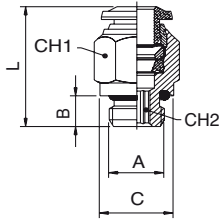

Code	Hose	A	B	C	L	CH1	CH2
50020N.03.05	3	M5	4	8	19	8	2
50020N.04.05	4	M5	4	8	21	10	2
50020N.04.10	4	1/8	6	13	20	10	3
50020N.04.13	4	1/4	8	16	19.5	16	3
50020N.05.05	5	M5	4	8	23.5	12	2
50020N.05.10	5	1/8	6	13	22	12	4
50020N.06.05	6	M5	4	10	24.5	13	2
50020N.06.10	6	1/8	6	13	23.5	13	4
50020N.06.13	6	1/4	8	16	23.5	13	4
50020N.08.10	8	1/8	6	13	25	14	5
50020N.08.13	8	1/4	8	16	23	14	6
50020N.08.17	8	3/8	9	20	24	14	6
50020N.10.13	10	1/4	8	16	30.5	17	6
50020N.10.17	10	3/8	9	20	27.5	17	8
50020N.12.17	12	3/8	9	20	34	20	8
50020N.12.21	12	1/2	10	25	31	22	10
50020N.14.17	14	3/8	9	20	35	21	10
50020N.14.21	14	1/2	10	25	32	22	10

Straight Female Adaptor (series 50030N)

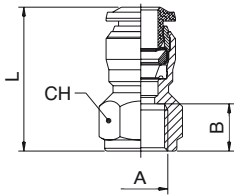

Code	Hose	A	B	L	CH
50030N.03.05	3	M5	5.5	18.5	9
50030N.04.10	4	1/8	8.5	24	13
50030N.05.10	5	1/8	8.5	26.5	13
50030N.06.10	6	1/8	8.5	26	13
50030N.06.13	6	1/4	11	29.5	16
50030N.08.10	8	1/8	8.5	27	15
50030N.08.13	8	1/4	11	29.5	17

Straight Connector (series 50040N)

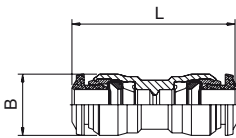

Code	Hose ₁	Hose ₂	B	L
50040N.03.00	3	3	8.5	26
50040N.04.00	4	4	10.5	30.5
50040N.05.00	5	5	11.5	33
50040N.06.04	6	4	12.5	32
50040N.06.00	6	6	12.5	34
50040N.08.06	8	6	14.5	35
50040N.08.00	8	8	14.5	36
50040N.10.00	10	10	17.5	42
50040N.12.00	12	12	47	20.5
50040N.14.00	14	14	21.5	49

Bulkhead Connector (series 50050N)

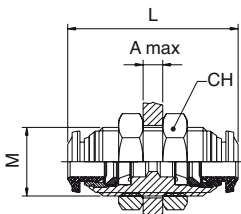

Code	Hose	M	L	A _{max}	CH
50050N.03.00	3	M10x1	26	5	14
50050N.04.00	4	M12x1	31.5	7	17
50050N.05.00	5	M14x1	33	7	17
50050N.06.00	6	M14x1	35	9.5	17
50050N.08.00	8	M16x1	37	10.5	19
50050N.10.00	10	M20x1	43	12.5	24
50050N.12.00	12	M22x1	48	16.5	26

Orienting Elbow Male Adaptor - Parallel (series 50116N)

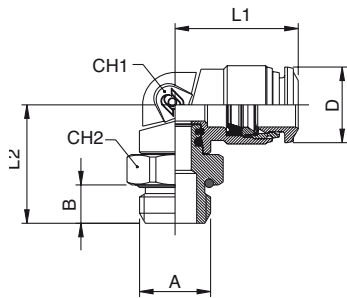

Code	Hose	A	B	L1	L2	CH1	CH2	D
50116N.03.05	3	M5	3.5	16.6	17.5	9	8	10
50116N.04.05	4	M5	3.5	18	17.5	9	8	10
50116N.04.10	4	1/8	5.5	18	18	9	13	10
50116N.04.13	4	1/4	7	18	18	9	16	10
50116N.05.05	5	M5	3.5	20	20	11	11	12.5
50116N.05.10	5	1/8	5.5	20	20	11	13	12.5
50116N.06.05	6	M5	3.5	21	20	11	11	12.5
50116N.06.10	6	1/8	5.5	21	20	11	13	12.5
50116N.06.13	6	1/4	7	21	21.5	11	16	12.5
50116N.08.10	8	1/8	5.5	22.5	22.5	12	13	14.5
50116N.08.13	8	1/4	7	22.5	23	12	16	14.5
50116N.08.17	8	3/8	8	22.5	25	12	20	14.5
50116N.08.21	8	1/2	9.5	22.5	26.5	12	25	14.5
50116N.10.13	10	1/4	7	26.5	25.5	14	16	17.5
50116N.10.17	10	3/8	8	26.5	25	14	20	17.5
50116N.10.21	10	1/2	9.5	26.5	26.5	14	25	17.5
50116N.12.17	12	3/8	8	31.5	27	16	20	21.5
50116N.12.21	12	1/2	9.5	31.5	28.5	16	25	21.5
50116N.14.17	14	3/8	8	31.5	27.5	16	20	21.5
50116N.14.21	14	1/2	9.5	31.5	29	16	25	21.5

Extended Orienting Elbow Male Adaptor - Parallel (series 50126N)

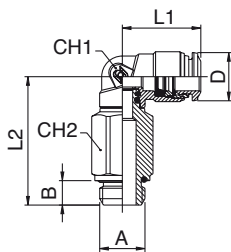

Code	Hose	A	B	L1	L2	CH1	CH2	D
50126N.04.10	4	1/8	5.5	18	30	9	12	10
50126N.04.13	4	1/4	7	18	32	9	15	10
50126N.05.10	5	1/8	5.5	20	34.5	11	12	12.5
50126N.06.10	6	1/8	5.5	21	34.5	11	12	12.5
50126N.06.13	6	1/4	7	21	36	11	15	12.5
50126N.08.10	8	1/8	5	23	39	12	12	14.5
50126N.08.13	8	1/4	7	22.5	39.5	12	15	14.5
50126N.08.17	8	3/8	8	22.5	41.5	12	18	14.5
50126N.10.13	10	1/4	7	26.5	45	14	16	17.5
50126N.10.17	10	3/8	8	26.5	44.5	14	18	17.5

Elbow Connector (series 50130N)

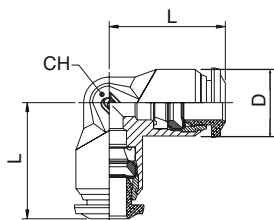

Code	Hose	L	CH	D
50130N.03.00	3	17	9	10
50130N.04.00	4	17	9	10
50130N.05.00	5	20	11	12.5
50130N.06.00	6	21	11	12.5
50130N.08.00	8	22.5	13	14
50130N.10.00	10	26.5	16	17
50130N.12.00	12	30.5	19	21.5
50130N.14.00	14	32.5	19	21.5

Orienting Tee Male Adaptor - Parallel (series 50216N)

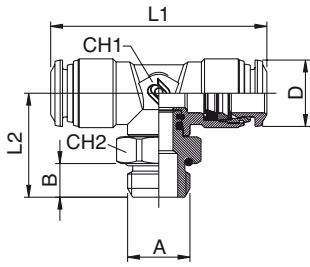

Code	Hose	A	B	L1	L2	CH1	CH2	D
50216N.03.05	3	M5	3.5	33	17	9	8	10
50216N.04.05	4	M5	3.5	34	18	9	8	10
50216N.04.10	4	1/8	5.5	34	18.5	9	13	10
50216N.04.13	4	1/4	7	34	20	9	16	10
50216N.05.05	5	M5	3.5	40	20.5	11	11	12.5
50216N.05.10	5	1/8	5.5	40	20.5	11	13	12.5
50216N.06.05	6	M5	3.5	42	20.5	11	11	12.5
50216N.06.10	6	1/8	5.5	42	20.5	11	13	12.5
50216N.06.13	6	1/4	7	42	22	11	16	12.5
50216N.08.10	8	1/8	5.5	45	23.5	13	13	14.5
50216N.08.13	8	1/4	7	45	24	13	16	14.5
50216N.10.13	10	1/4	7	53	27.5	14	16	17.5
50216N.10.17	10	3/8	8	53	27	14	20	17.5
50216N.10.21	10	1/2	9.5	53	28.5	14	25	17.5
50216N.12.17	12	3/8	8	62.5	29.5	16	20	21.5
50216N.12.21	12	1/2	9.5	62.5	31	16	25	21.5
50216N.14.17	14	3/8	8	62.5	29.5	16	20	21.5
50216N.14.21	14	1/2	9.5	62.5	31	16	25	21.5

Orienting Tee Male Adaptor Lateral - Parallel (series 50226N)

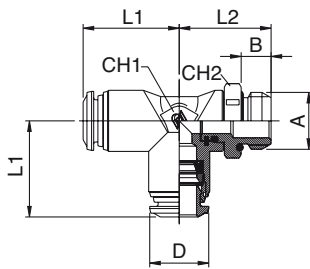

Code	Hose	A	B	L1	L2	CH1	CH2	D
50226N.03.05	3	M5	3.5	16.5	17	9	8	10
50226N.04.05	4	M5	3.5	17	18	9	8	10
50226N.04.10	4	1/8	5.5	17	18.5	9	13	10
50226N.04.13	4	1/4	7	17	20	9	16	10
50226N.05.05	5	M5	3.5	20	20.5	11	11	12.5
50226N.05.10	5	1/8	5.5	20	20.5	11	13	12.5
50226N.06.05	6	M5	3.5	21	20.5	11	11	12.5
50226N.06.10	6	1/8	5.5	21	20.5	11	13	12.5
50226N.06.13	6	1/4	7	21	22	11	16	12.5
50226N.08.10	8	1/8	5.5	22.5	22.5	13	13	14.5
50226N.08.13	8	1/4	7	22.5	24	13	16	14.5
50226N.10.13	10	1/4	7	26.5	27	14	16	17.5
50226N.10.17	10	3/8	8	26.5	26.5	14	20	17.5
50226N.10.21	10	1/2	9.5	26.5	28	14	25	17.5
50226N.12.17	12	3/8	8	31.5	29.5	16	20	21.5
50226N.12.21	12	1/2	9.5	31.5	31	16	25	21.5

Tee Connector (series 50230N)

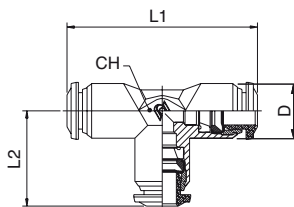

Code	Hose	L1	L2	D	CH
50230N.03.00	3	34	17	10	9
50230N.04.00	4	34	17	10	9
50230N.05.00	5	40	20	12.5	11
50230N.06.00	6	42	21	12.5	11
50230N.08.00	8	45	22.5	14	13
50230N.10.00	10	53	26.5	17	16
50230N.12.00	12	61	30.5	21.5	19
50230N.14.00	14	32.5	65	21.5	19

Y Connector (series 50310N)

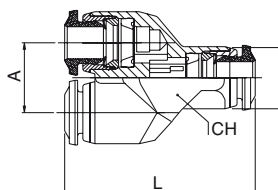

Code	Hose	A	L	D	CH
50310N.03.00	3	10	29	10	9
50310N.04.00	4	11	32	10	9
50310N.05.00	5	13.5	35	12.5	11
50310N.06.00	6	13.5	36.5	12.5	11
50310N.08.00	8	15.5	41	14	13

Single Banjo Body (series 50500N)

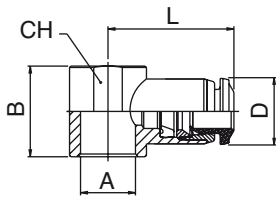

Code	Hose	A	B	L	D	CH
50500N.03.05	3	M5	12.5	19	10	-
50500N.03.06	3	M6	12.5	19	10	-
50500N.04.05	4	M5	12.5	19	10	-
50500N.04.06	4	M6	12.5	19	10	-
50500N.04.10	4	1/8	15	21	10	14
50500N.05.05	5	M5	12.5	20	12.5	-
50500N.05.06	5	M6	12.5	20	12.5	-
50500N.05.10	5	1/8	15	21.5	12.5	14
50500N.05.13	5	1/4	17	24.5	12.5	18
50500N.06.05	6	M5	12.5	20.5	12.5	-
50500N.06.06	6	M6	12.5	20.5	12.5	-
50500N.06.10	6	1/8	15	22	12.5	14
50500N.06.13	6	1/4	17	25	12.5	18
50500N.08.10	8	1/8	15	24	14	14
50500N.08.13	8	1/4	17	26	14	18
50500N.08.17	8	3/8	20	28	14	21
50500N.10.13	10	1/4	17	29	17	18
50500N.10.17	10	3/8	20	30.5	17	21
50500N.12.17	12	3/8	20	32.5	21.5	21

Note: The single banjo body should be mounted on the hollow bolt.

Double Banjo Body (series 50510N)

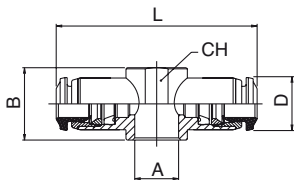

Code	Hose	A	B	L	D	CH
50510N.04.05	4	M5	12.5	38	10	-
50510N.04.06	4	M6	12.5	38	10	-
50510N.04.10	4	1/8	15	42	10	14
50510N.05.10	5	1/8	15	43	12.5	14
50510N.05.13	5	1/4	17	49	12.5	18
50510N.06.10	6	1/8	15	44	12.5	14
50510N.06.13	6	1/4	17	50	12.5	18
50510N.08.10	8	1/8	15	48	14	14
50510N.08.13	8	1/4	17	52	14	18

Note: The double banjo body should be mounted on the hollow bolt.

Single Hollow Bolt (series 51410N)

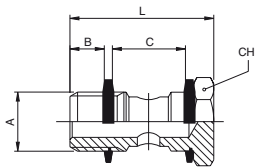

Code	A	B	C	L	CH
51410N.05.00	M5	4	12.5	22	8
51410N.06.00	M6	5	12.5	23	8
51410N.10.00	1/8	6	15	28	14
51410N.13.00	1/4	8	17	32	17
51410N.17.00	3/8	9	20	36	19

Double Hollow Bolt (series 51420N)

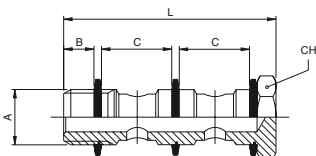

Code	A	B	C	L	CH
51420N.10.00	1/8	6	15	44.5	14
51420N.13.00	1/4	8	17	50.5	17
51420N.17.00	3/8	9	20	58	19

Triple Hollow Bolt (series 51430N)

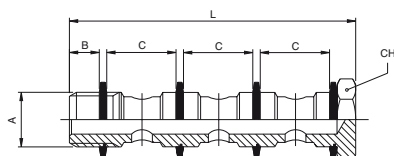

Code	A	B	C	L	CH
51430N.10.00	1/8	6	15	61	14
51430N.13.00	1/4	8	17	69	17
51430N.17.00	3/8	9	20	80	19

Taper Nipple (male - male)

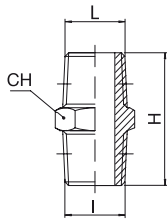

Code	I	L	H	CH
RA02.18.18	1/8	1/8	20.5	12
RA02.18.14	1/8	1/4	24	14
RA02.18.38	1/8	3/8	24.5	17
RA02.14.14	1/4	1/4	27	14
RA02.14.38	1/4	3/8	27.5	17
RA02.14.12	1/4	1/2	30.5	22
RA02.38.38	3/8	3/8	28	17
RA02.38.12	3/8	1/2	31	22
RA02.12.12	1/2	1/2	33.5	22

Sleeve (female - female)

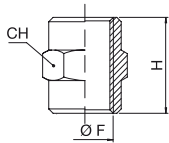

Code	F	H	CH
RA03.18	1/8	15	14
RA03.14	1/4	22	17
RA03.38	3/8	23	22
RA03.12	1/2	28	26

Reducing Sleeve (female - female)

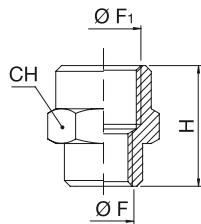

Code	F	F ₁	H	CH
RA06.18.14	1/8	1/4	19	17
RA06.18.38	1/8	3/8	20	22
RA06.14.38	1/4	3/8	22.5	22
RA06.14.12	1/4	1/2	26	24
RA06.38.12	3/8	1/2	26	24

Female Elbow

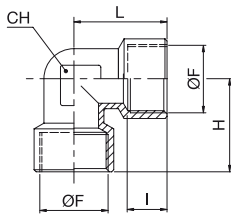

Code	F	I	L	CH	H
RA09.18.18	1/8	8	21	10	21
RA09.14.14	1/4	11	25.5	13	25.5
RA09.38.38	3/8	11.5	28	17	28
RA09.12.12	1/2	14	33.5	21	33.5

Male Elbow (taper)

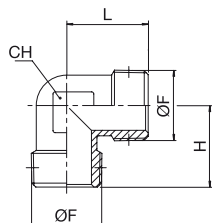

Code	F	H	CH	L
RA15.18	1/8	18.5	10	18.5
RA15.14	1/4	23.5	13	23.5
RA15.38	3/8	26	17	26
RA15.12	1/2	31	21	31

Elbow (male - female)

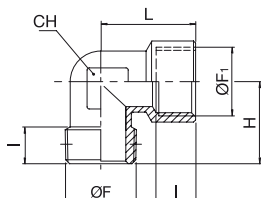

Code	F	F ₁	I	H	L	CH
RA10.18.18	1/8	1/8	8	18.5	21	10
RA10.14.14	1/4	1/4	11	23.5	21.5	13
RA10.38.38	3/8	3/8	11.5	26	28	17
RA10.12.12	1/2	1/2	14	31	33.5	21

Female Tee

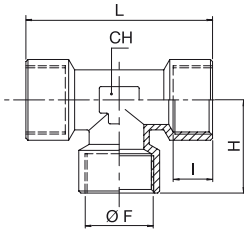

Code	F	I	H	L	CH
RA11.18	1/8	8	21	42	10
RA11.14	1/4	11	25.5	51	13
RA11.38	3/8	11.5	28	56	17
RA11.12	1/2	14	33.5	67	21

Male Tee (taper)

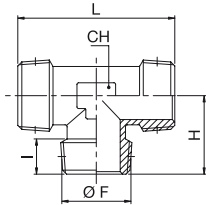

Code	F	I	H	L	CH
RA16.18	1/8	8	18.5	37	10
RA16.14	1/4	11	23.5	47	13
RA16.38	3/8	11.5	36	52	17
RA16.12	1/2	14	31	62	21

Off Set Female Tee

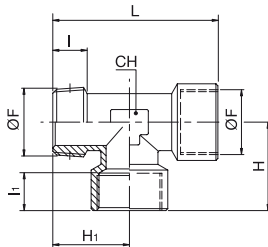

Code	F	H	H ₁	I	I ₁	L	CH
RA13.18.18	1/8	21	18.5	8	8	39.5	10
RA13.14.14	1/4	25.5	23.5	11	11	49	13
RA13.38.38	3/8	28	26	11.5	11.5	54	17
RA13.12.12	1/2	33.5	31	14	14	64.5	21

Off Set Male Tee

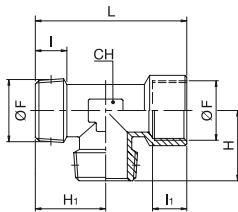

Code	F	H	H ₁	I	I ₁	L	CH
RA18.18.18	1/8	18.5	18.5	8	8	39.5	10
RA18.14.14	1/4	23.5	23.5	11	11	49	13
RA18.38.38	3/8	26	26	11.5	11.5	54	17
RA18.12.12	1/2	31	31	14	14	64.5	21

Centre Leg Male Tee

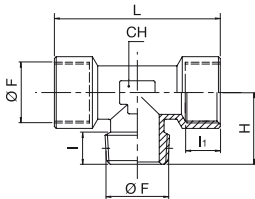

Code	F	H	I	I ₁	L	CH
RA12.18.18	1/8	18.5	8	8	42	10
RA12.14.14	1/4	23.5	11	11	51	13
RA12.38.38	3/8	26	11.5	11.5	56	17
RA12.12.12	1/2	31	14	14	67	21

Centre Leg Female Tee

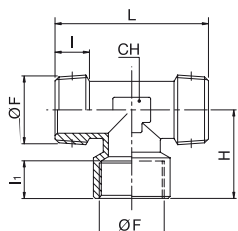

Code	F	H	I	I ₁	L	CH
RA17.18.18	1/8	21	8	8	37	10
RA17.14.14	1/4	25.5	11	11	47	13
RA17.38.38	3/8	28	11.5	11.5	52	17
RA17.12.12	1/2	33.5	14	14	62	21

Y Male 90°

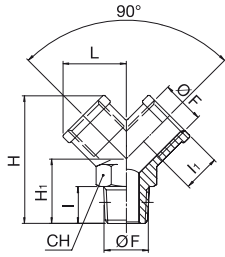

Code	F	I	I ₁	H	H ₁	L	CH
RY08	1/8	8	8	32	16	14.5	13
RY04	3/4	11	11	38	20	18	17
RY03	3/8	11.5	11.5	42.5	22	20.5	20

Taper Reducer (male - female)

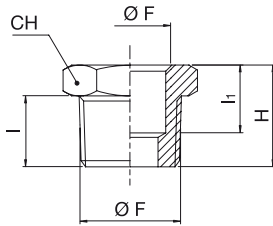

Code	F	F ₁	I	I ₁	H	CH
RA04.14.18	1/4	1/8	11	8	16	14
RA04.38.18	3/8	1/8	11.5	8	16.5	17
RA04.38.14	3/8	1/4	11.5	11	16.5	17
RA04.12.14	1/2	1/4	14	11	19.5	22
RA04.12.38	1/2	3/8	14	11.5	19.5	22
RA04.34.12	3/4	1/2	16.5	14	23	27

Long Taper Reducer (male - female)

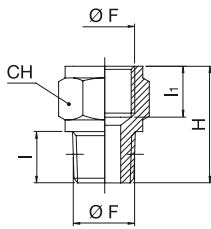

Code	F	F ₁	I	I ₁	H	CH
RA05.18.18	1/8	1/8	8	8	18	14
RA05.18.14	1/8	1/4	8	11	21.5	17
RA05.14.14	1/4	1/4	11	11	24.5	17
RA05.14.38	1/4	3/8	11	11.5	25.5	22
RA05.38.12	3/8	1/2	11.5	14	29.5	24
RA05.38.38	3/8	3/8	11.5	11.5	26	22
RA05.12.12	1/2	1/2	14	14	32	26

Cross Manifold

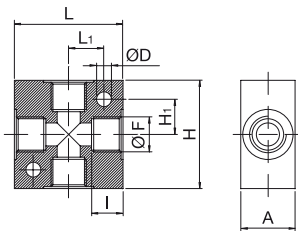

Code	F	I	H	H ₁	L	L ₁	A	D
RA21.18	1/8	8	25	8.5	25	8.5	16	4.5
RA21.14	1/4	11	40	13	40	13	20	5.5
RA21.38	3/8	11.5	40	17	40	17	25	5.5
RA21.12	1/2	14	50	17	50	17	30	5.5

Male Hose Adapter (parallel)

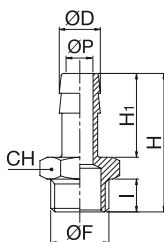

Code	F	D	P	I	H	H ₁	CH
RA19.07.18	1/8	7	4	6	29.5	19	12
RA19.07.14	1/4	7	4	8	32	19	14
RA19.09.18	1/8	9	6	6	29.5	19	12
RA19.09.14	1/4	9	6	8	32	19	14
RA19.09.38	3/8	9	6	9	33	19	19
RA19.12.14	1/4	12	9	8	33	20	14
RA19.12.38	3/8	12	9	9	34	20	19
RA19.12.12	1/2	12	9	10	33.5	20	22
RA19.17.38	3/8	17	13	9	38	24	19
RA19.17.12	1/2	17	13	10	39.5	24	22

Male Plug (parallel)

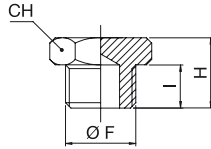

Code	F	H	I	CH
RA07.18	1/8	10	6	14
RA07.14	1/4	12.5	8	17
RA07.38	3/8	13.5	9	19
RA07.12	1/2	15.5	10	24

Male Plug (taper)

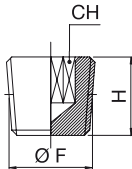

Code	F	H	CH
TB8O	1/8	7.5	5
TB4O	1/4	10	6
TB3O	3/8	11	8
TB2O	1/2	13	10

Female Plug

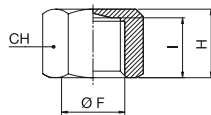

Code	F	H	I	CH
RA08.18	1/8	10	8	14
RA08.14	1/4	13.5	11	17
RA08.38	3/8	14	11.5	20
RA08.12	1/2	16.5	14	24

Nut

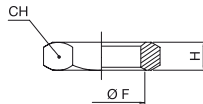

Code	F	H	CH
DB08	1/8	4.5	14
DB04	1/4	5	17
DB03	3/8	5.5	19
DB02	1/2	6	24

Extension - Parallel

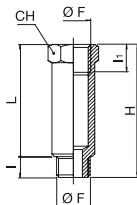

Code	F	L	I	I ₁	H	CH
PC08	1/8	16	6	8	22	14
PC04	1/4	27	8	11	35	17
PL08	1/8	36	6	8	42	14
PL04	1/4	43	8	11	51	17

Reducer - Parallel (male - female)

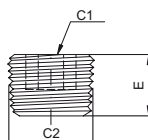

Code	C1	C2	E
BS02	1/2	3/8	10
BS03	3/8	1/4	9
BS04	1/4	1/8	8

Note: The reduction is not nickel plated.

Tube Coupling

Material: Brass

50.007

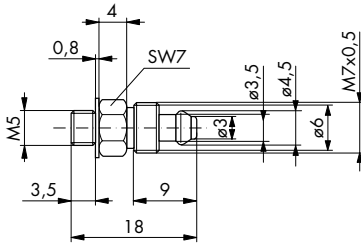

50.046

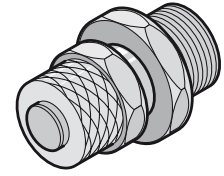
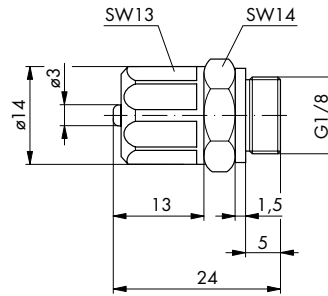

50.008

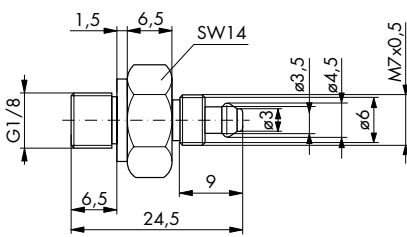

50.021

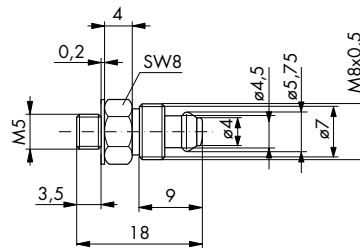

Code	Tube	Connection
50.007*	5x1	M5
50.008*	5x1	G 1/8
50.046*	6x1	G 1/8
50.021*	6x1	M5

* Supplied complete with seals.

Tube Coupling - L-banjo for 5 x 1 tubing

Material: Brass

50.130

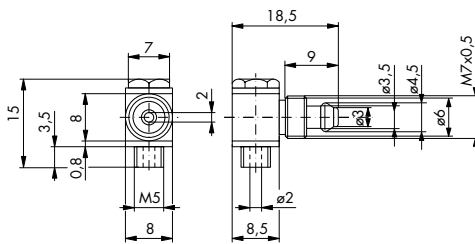

50.170

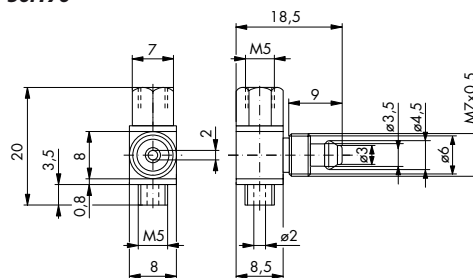

Code
50.130
50.170

Note: The shipment includes the nut.

Tube Coupling - L-banjo for 6 x 1 tubing

Material: Brass

50.191

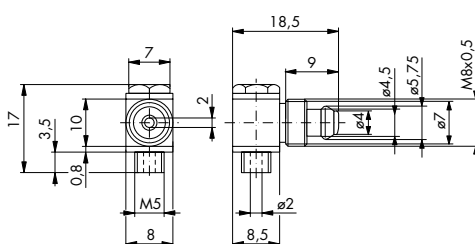

50.192

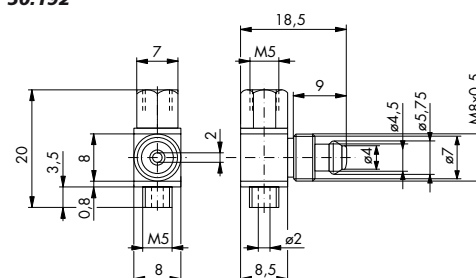

Code
50.191
50.192

Note: The shipment includes the nut.

Tube Coupling - Rotary distributor for 5 x 1 tubing

Movement: Swivelling screw for slow rotary movement

Material: Brass

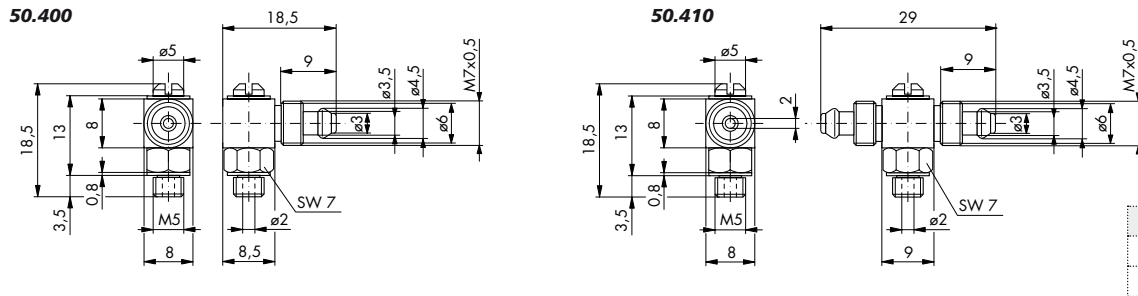

Code
50.400
50.410

Note: The shipment includes the nut and seals.

Tube Coupling - Rotary distributor for 6 x 1 tubing

Movement: Swivelling screw for slow rotary movement

Material: Brass

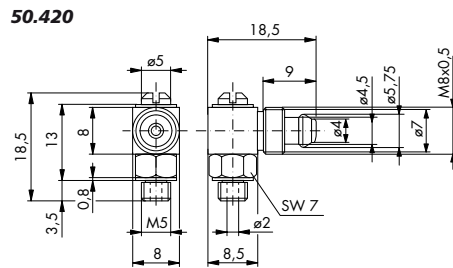

Code
50.420

Note: The shipment includes the nut and seals.

Tube Coupling

Material: Brass

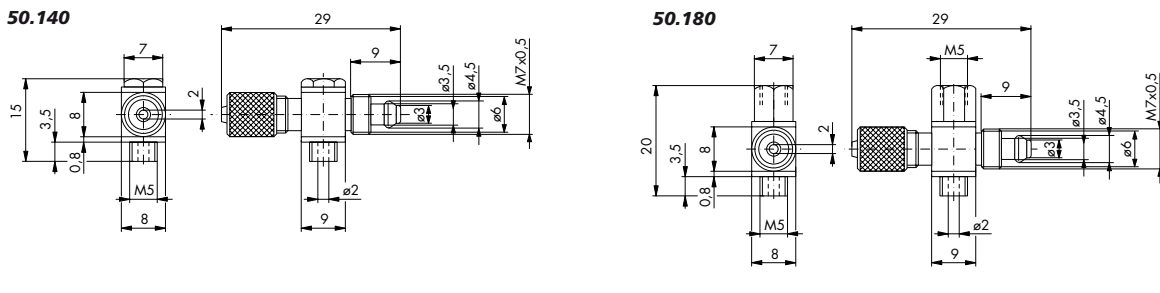

Code
50.140
50.180

Note: The shipment includes the nut.

L-banjo for M5 Connection

Material: Brass

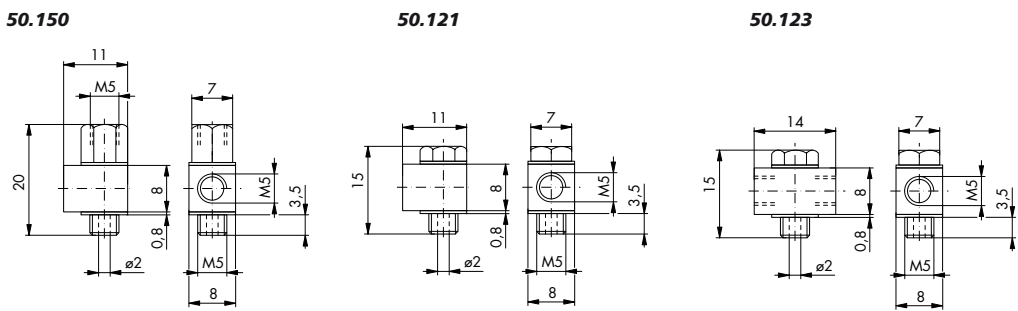

Code	Type
50.150	L-Banjo
50.121	L-Banjo
50.123	T-Banjo

Tube Coupling - Bulkhead coupling for 5 x 1 tubing

Material: Brass

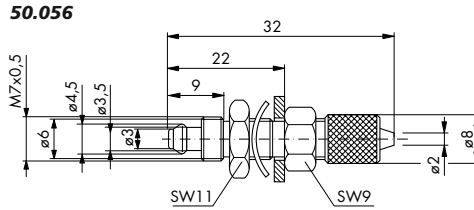

Code
50.056

Tube Coupling - Socket

50.062

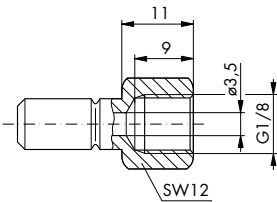

50.063

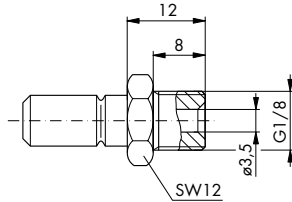

50.064

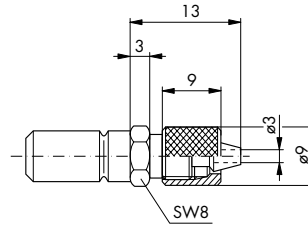

50.065

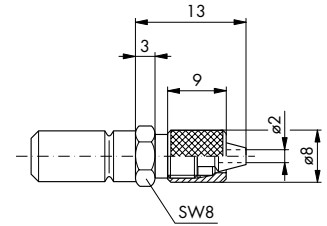

Code	Type
50.062	G 1/8 female
50.063	G 1/8 male
50.064	Socket 6 x 1 tubing
50.065	Socket 5 x 1 tubing

Tube Coupling and Nipple

Pressure range: Max. 8 bar

Material: High grade Polyamide

Ambient temperature range: -10 °C...+70 °C

Adm. Tightening torque: Max. 0.5 Nm

50.706

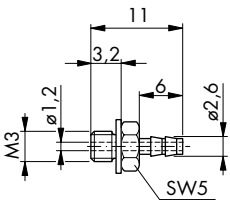

50.036

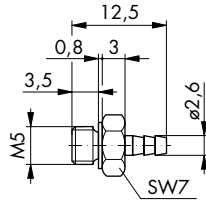

50.040

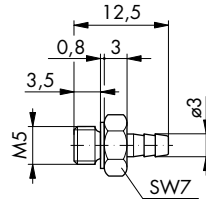

50.704

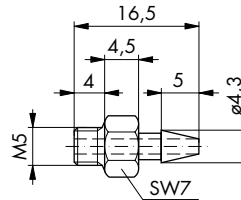

50.045

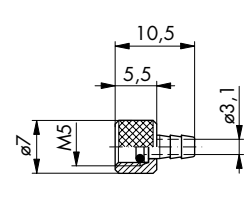

Code	Type
50.706	Tube nipple for 4 x 1 tubing (for hose Order No. 50.203)
50.036	Tube nipple for 4 x 1 tubing (for hose Order No. 50.203)
50.040	Tube nipple for 4 x 1 tubing (PVC)
50.704	Tube nipple for 5 x 1 tubing (self-sealing on thread)
50.045	Tube coupling for 4 x 1 tubing (PVC)

Note: The shipment includes the seals.

Silencer

50.030

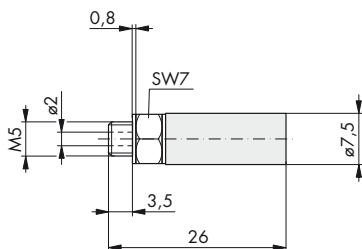

52.115

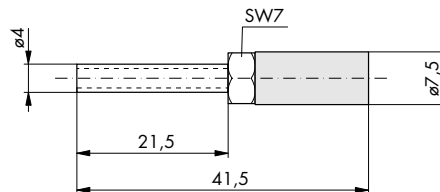

Code
50.030
52.115

Tube Coupling - Socket

Material: Brass

50.627

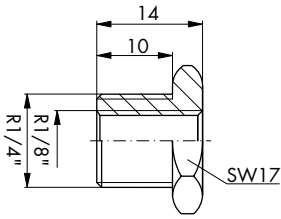

50.052

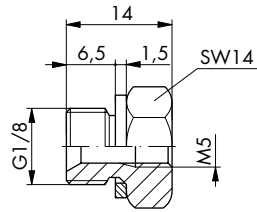

50.054

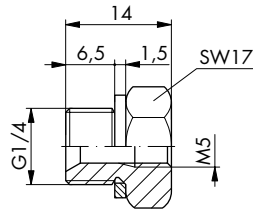

Code	Type
50.627	G 1/4 - G 1/8
50.052	G 1/8 - M5
50.054	G 1/4 - M5

Note: The shipment includes the seals.

Reducing sleeve

Reduction: G 1/8 - M5

Material: Brass

50.053

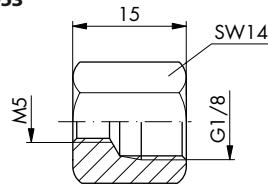

Code
50.053

Double nipple

Material: Brass

50.050

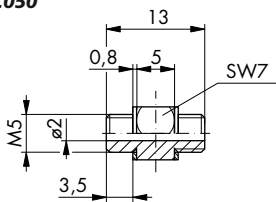

50.100

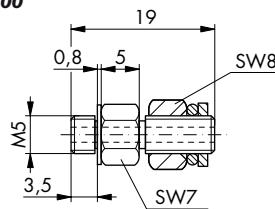

Code	Type
50.050	Double nipple
50.100	Double nipple M5 with lock nut

Blanking plug

Material: Brass

50.500

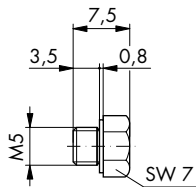

50.501

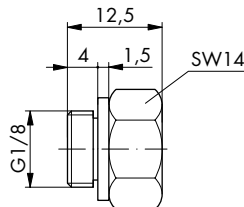

Code	Type
50.500	Blanking plug M5
50.501	Blanking plug G 1/8

Coupling

Material: Brass

50.009

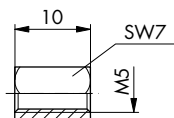

50.051

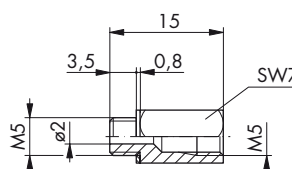

Code	Type
50.009	Coupling sleeve
50.051	Coupling piece

Manifold M5

Material: Brass

Connection: M5

50.120

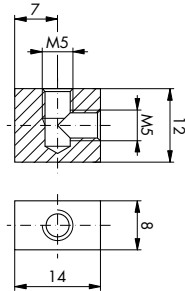

50.122

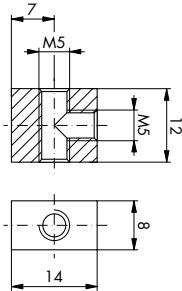

50.124

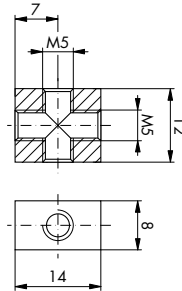

Code	Type
50.120	L-manifold
50.122	T-manifold
50.124	X-manifold

Volumes & Mounting Clip

Pressure range: Max. 8 bar

50.034

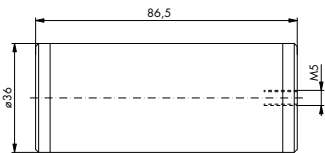

50.033

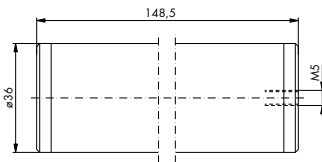

Code	Type
50.034	Volume 50 cm ³
50.033	Volume 100 cm ³

Note: Used with clip 50.043.

Manifold

Material: Brass, aluminium

50.222

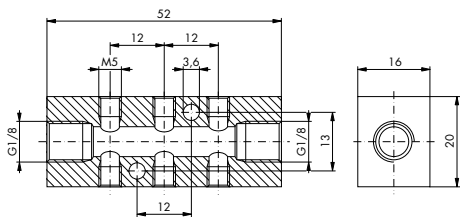

50.224

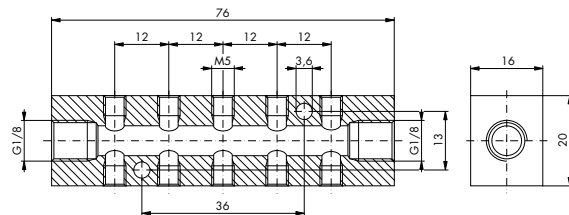

50.226.04

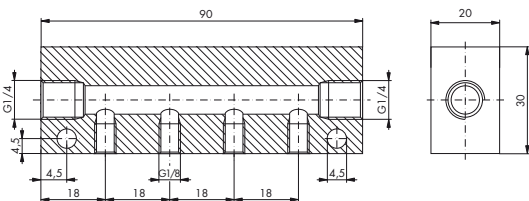

Code	Input	Output	Material
50.222	2 x G1/8	6 x M5	Brass
50.224	2 x G1/8	10 x M5	Brass
50.226.04	2 x G1/4	4 x G1/8	Aluminium

Seals

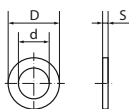

Code	To suit	D	d	S	Contents
50.001	M5	7.5	4.5	0.8	100
50.010	G1/8	13.5	10	1.5	100
50.002	G1/4	17	13.3	1.5	100
50.029	Top seal for banjo fittings	8	5.1	0.5	100

BSG PNEUMATIC ACCESSORIES AIR TREATMENT UNITS

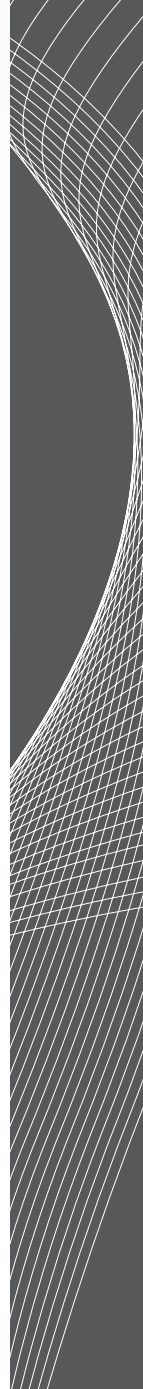

AIR TREATMENT UNITS

General Information

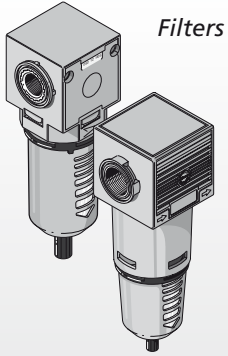

Pressure Regulators

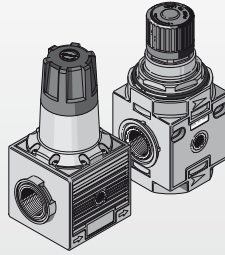

Lubricators

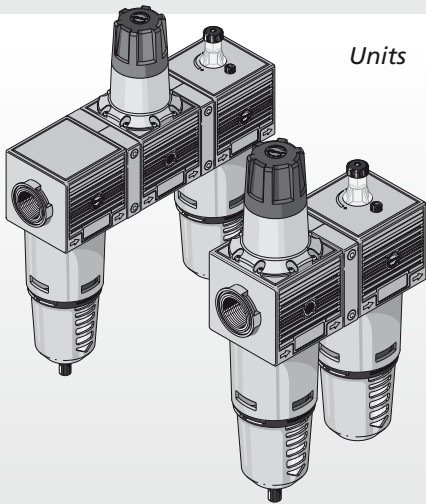
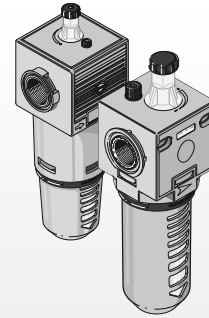

Filter Regulators

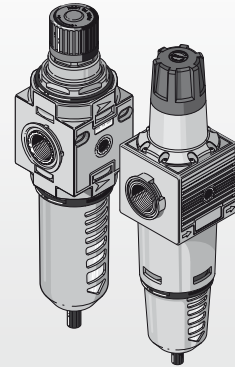

Shut-off Valves

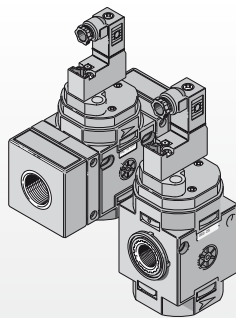

Micro-regulators

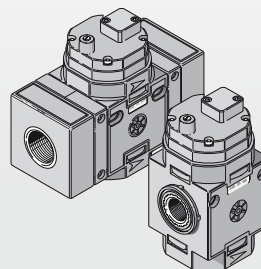
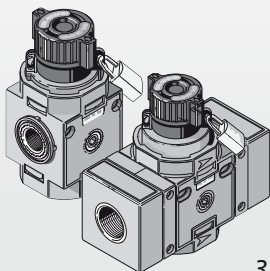
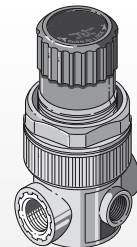

ACCESSORIES
AIR TREATMENT UNITS

Filter - G1/4

Filtration grade:	20 µm
Max. pressure available:	12.5 bar
Temperature range:	5 - 50°C
Condensate cup capacity:	22 cc
Q_{rit} (p=6.3 bar):	850 NI/min

Device for condensate draining manual and semi-automatic
Polyamide bowl with protection (transparent upon request)

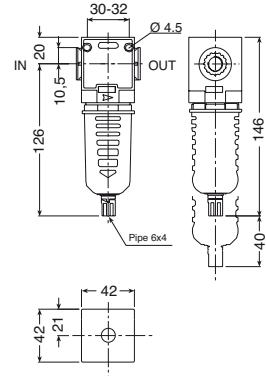
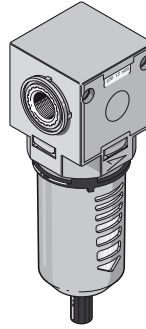

Code
F4STP

Filter - G3/8

Filtration grade:	20 µm
Max. pressure available:	12.5 bar
Temperature range:	5 - 50°C
Condensate cup capacity:	42 cc
Q_{rit} (p=6.3 bar):	2100 NI/min

Device for condensate draining manual and semi-automatic
Polyamide bowl with protection (transparent upon request)

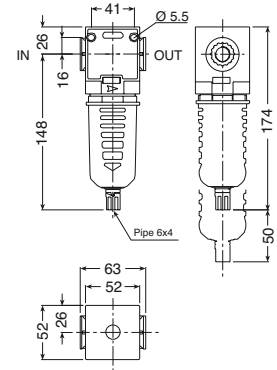
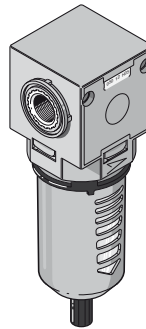

Code
F3STP

Filter - G1/2

Filtration grade:	20 µm
Max. pressure available:	12.5 bar
Temperature range:	5 - 50°C
Condensate cup capacity:	100 cc
Q_{rit} (p=6.3 bar):	2300 NI/min

Device for condensate draining manual and semi-automatic
Polyamide bowl with protection (transparent upon request)

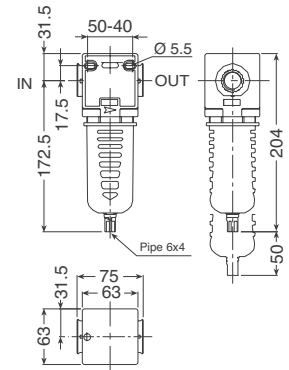
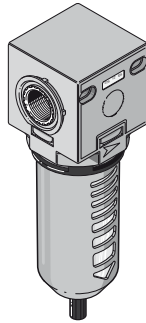

Code
F2STP

Filter - G1

Filtration grade:	20 µm
Max. pressure available:	12.5 bar
Temperature range:	5 - 50°C
Condensate cup capacity:	200 cc
Q_{rit} (p=6.3 bar):	11250 NI/min

Device for condensate draining manual and semi-automatic
Polyamide bowl with protection (transparent upon request)

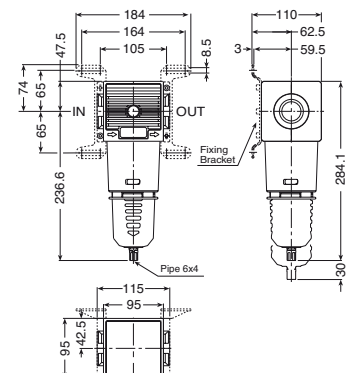
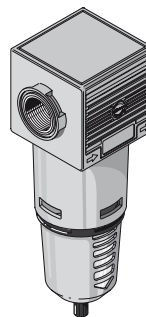

Code
F10STP

Pressure Regulator - G1/4

Input P_{max}	12.5 bar
Pressure regulation range:	0 - 8 bar
Temperature range:	5 - 50°C
Q_{ref} ($p=6.3$ bar):	850 NI/min
Pressure gauge connection:	G1/8

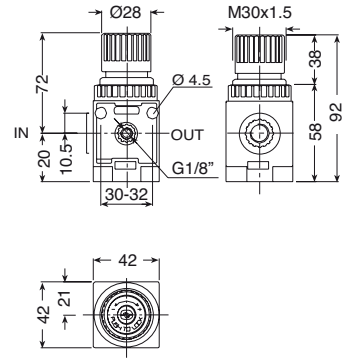
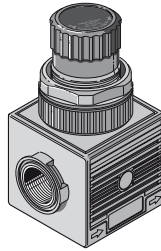

Code
R4ST

Pressure Regulator - G3/8

Input P_{max}	12.5 bar
Pressure regulation range:	0 - 8 bar
Temperature range:	5 - 50°C
Q_{ref} ($p=6.3$ bar):	1500 NI/min
Pressure gauge connection:	G1/8

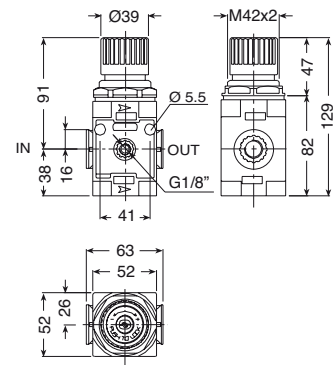
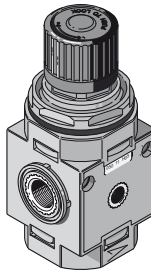

Code
R3ST

Pressure Regulator - G1/2

Input P_{max}	12.5 bar
Pressure regulation range:	0 - 8 bar
Temperature range:	5 - 50°C
Q_{ref} ($p=6.3$ bar):	2300 NI/min
Pressure gauge connection:	G1/8

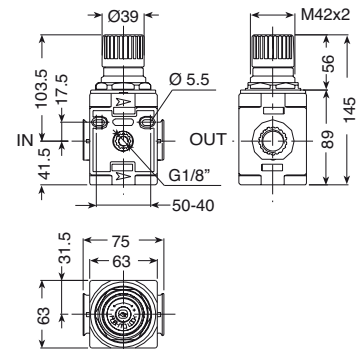
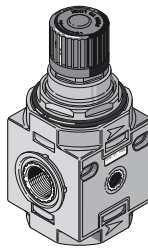

Code
R2ST

Pressure Regulator - G1

Input P_{max}	12.5 bar
Pressure regulation range:	0 - 8 bar
Temperature range:	5 - 50°C
Q_{ref} ($p=6.3$ bar):	15000 NI/min
Pressure gauge connection:	G1/4

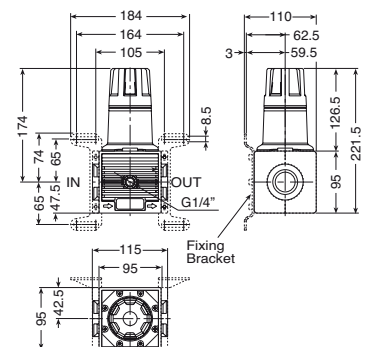
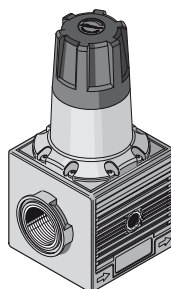

Code
R10ST

Lubricator - G1/4

Max. pressure available:	12.5 bar
Temperature range:	5 - 50°C
Bowl capacity:	42 cc
Q_{rit} ($p=6.3$ bar):	1500 NI/min
Recommended viscosity:	ISO VG32

Polyamide bowl with protection (transparent upon request)

Code
L4STP

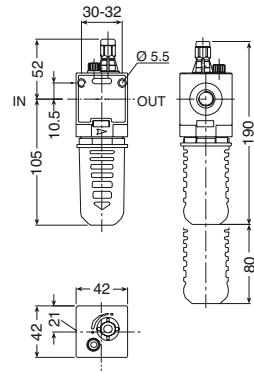
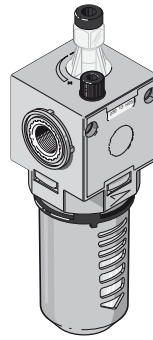

Lubricator - G3/8

Max. pressure available:	12.5 bar
Temperature range:	5 - 50°C
Bowl capacity:	68 cc
Q_{rit} ($p=6.3$ bar):	1700 NI/min
Recommended viscosity:	ISO VG32

Polyamide bowl with protection (transparent upon request)

Code
L3STP

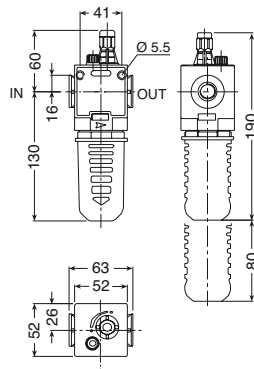
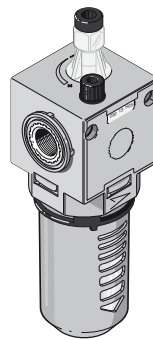

Lubricator - G1/2

Max. pressure available:	12.5 bar
Temperature range:	5 - 50°C
Bowl capacity:	140 cc
Q_{rit} ($p=6.3$ bar):	3000 NI/min
Recommended viscosity:	ISO VG32

Polyamide bowl with protection (transparent upon request)

Code
L2STP

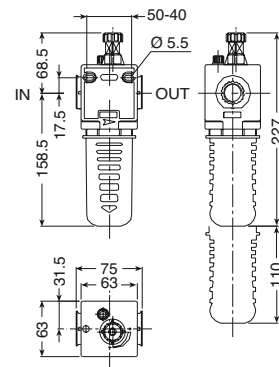
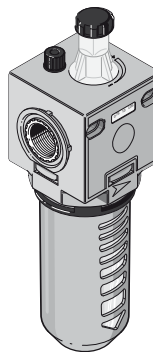

Lubricator - G1

Max. pressure available:	12.5 bar
Temperature range:	5 - 50°C
Bowl capacity:	440 cc
Q_{rit} ($p=6.3$ bar):	12000 NI/min
Recommended viscosity:	ISO VG32

Polyamide bowl with protection (transparent upon request)

Code
L10STP

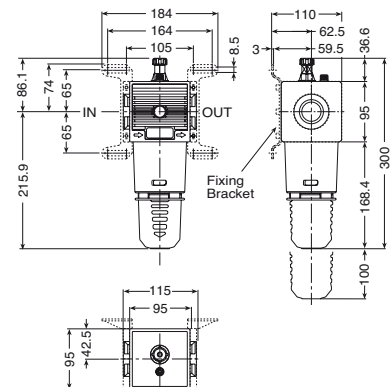
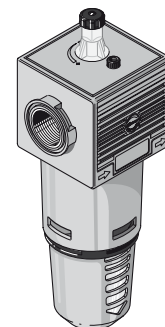

Unit Filter + Regulator + Lubricator - G1/4

Filtration grade:	20 µm
Max. pressure available:	12.5 bar
Pressure regulation range:	0 - 8 bar
Temperature range:	5 - 50°C
Condensate cup capacity:	22 cc
Q_{ref} (p=6.3 bar):	850 NI/min

Device for condensate draining manual and semi-automatic
Polyamide bowl with protection (transparent upon request)

Code
FRL4STP

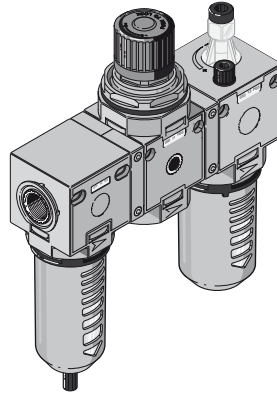

Unit Filter + Regulator + Lubricator - G3/8

Filtration grade:	20 µm
Max. pressure available:	12.5 bar
Pressure regulation range:	0 - 8 bar
Temperature range:	5 - 50°C
Condensate cup capacity:	42 cc
Q_{ref} (p=6.3 bar):	1500 NI/min

Device for condensate draining manual and semi-automatic
Polyamide bowl with protection (transparent upon request)

Code
FRL3STP

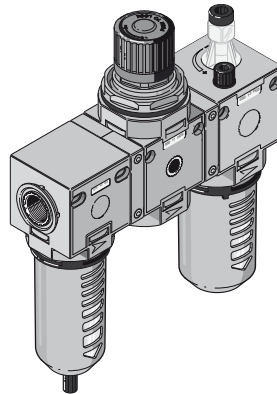

Unit Filter + Regulator + Lubricator - G1/2

Filtration grade:	20 µm
Max. pressure available:	12.5 bar
Pressure regulation range:	0 - 8 bar
Temperature range:	5 - 50°C
Condensate cup capacity:	100 cc
Q_{ref} (p=6.3 bar):	2300 NI/min

Device for condensate draining manual and semi-automatic
Polyamide bowl with protection (transparent upon request)

Code
FRL2STP

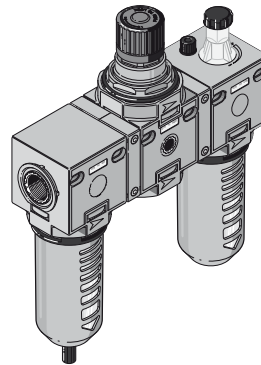

Unit Filter + Regulator + Lubricator - G1

Filtration grade:	20 µm
Max. pressure available:	12.5 bar
Pressure regulation range:	0 - 8 bar
Temperature range:	5 - 50°C
Condensate cup capacity:	200 cc
Q_{ref} (p=6.3 bar):	11250 NI/min

Device for condensate draining manual and semi-automatic
Polyamide bowl with protection (transparent upon request)

Code
FRL10STP

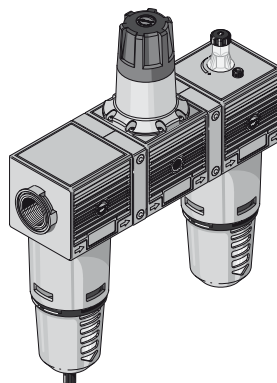

Unit Filter Regulator + Lubricator - G1/4

Filtration grade:	20 µm
Max. pressure available:	12.5 bar
Pressure regulation range:	0 - 8 bar
Temperature range:	5 - 50°C
Condensate cup capacity:	22 cc
Q_{rit} (p=6.3 bar):	850 NI/min

Device for condensate draining manual and semi-automatic
Polyamide bowl with protection (transparent upon request)

Code
FRL42STP

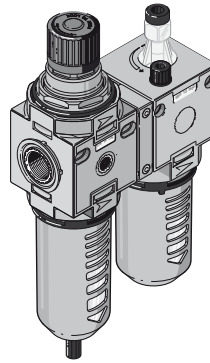

Unit Filter Regulator + Lubricator - G3/8

Filtration grade:	20 µm
Max. pressure available:	12.5 bar
Pressure regulation range:	0 - 8 bar
Temperature range:	5 - 50°C
Condensate cup capacity:	42 cc
Q_{rit} (p=6.3 bar):	1500 NI/min

Device for condensate draining manual and semi-automatic
Polyamide bowl with protection (transparent upon request)

Code
FRL32STP

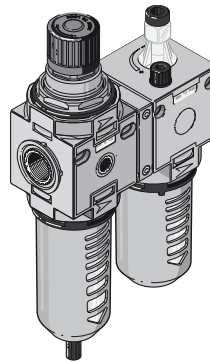

Unit Filter Regulator + Lubricator - G1/2

Filtration grade:	20 µm
Max. pressure available:	12.5 bar
Pressure regulation range:	0 - 8 bar
Temperature range:	5 - 50°C
Condensate cup capacity:	100 cc
Q_{rit} (p=6.3 bar):	2300 NI/min

Device for condensate draining manual and semi-automatic
Polyamide bowl with protection (transparent upon request)

Code
FRL22STP

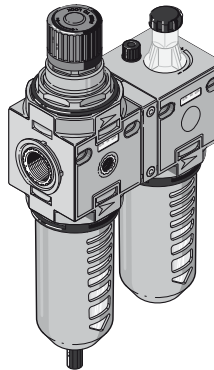

Unit Filter Regulator + Lubricator - G1

Filtration grade:	20 µm
Max. pressure available:	12.5 bar
Pressure regulation range:	0 - 8 bar
Temperature range:	5 - 50°C
Condensate cup capacity:	200 cc
Q_{rit} (p=6.3 bar):	12000 NI/min

Device for condensate draining manual and semi-automatic
Polyamide bowl with protection (transparent upon request)

Code
FRL102STP

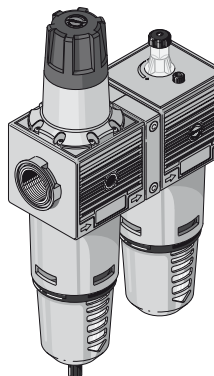

Filter Regulator - G1/4

Filtration grade:	20 µm
Max. pressure available:	12.5 bar
Pressure regulation range:	0 - 8 bar
Temperature range:	5 - 50°C
Condensate cup capacity:	22 cc
Q_{ref} (p=6.3 bar):	850 NI/min

Device for condensate draining manual and semi-automatic
Polyamide bowl with protection (transparent upon request)

Code
FR4STP

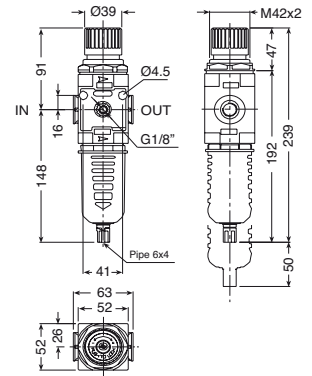
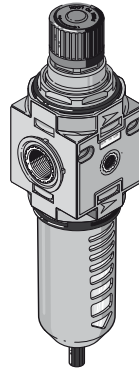

Filter Regulator - G3/8

Filtration grade:	20 µm
Max. pressure available:	12.5 bar
Pressure regulation range:	0 - 8 bar
Temperature range:	5 - 50°C
Condensate cup capacity:	42 cc
Q_{ref} (p=6.3 bar):	1500 NI/min

Device for condensate draining manual and semi-automatic
Polyamide bowl with protection (transparent upon request)

Code
FR3STP

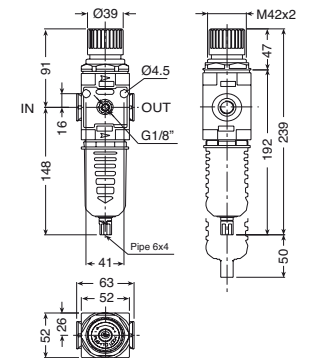
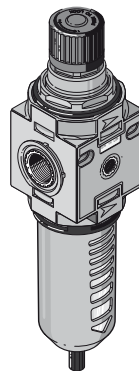

Filter Regulator - G1/2

Filtration grade:	20 µm
Max. pressure available:	12.5 bar
Pressure regulation range:	0 - 8 bar
Temperature range:	5 - 50°C
Condensate cup capacity:	100 cc
Q_{ref} (p=6.3 bar):	2300 NI/min

Device for condensate draining manual and semi-automatic
Polyamide bowl with protection (transparent upon request)

Code
FR2STP

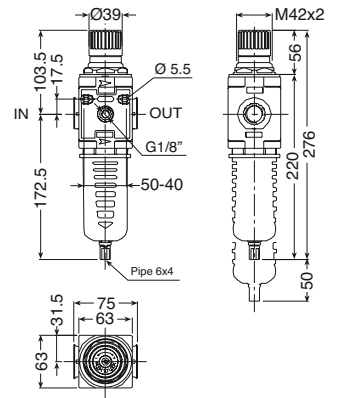
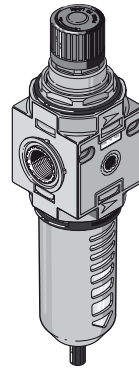

Filter Regulator - G1

Filtration grade:	20 µm
Max. pressure available:	12.5 bar
Pressure regulation range:	0 - 8 bar
Temperature range:	5 - 50°C
Condensate cup capacity:	200 cc
Q_{ref} (p=6.3 bar):	13800 NI/min

Device for condensate draining manual and semi-automatic
Polyamide bowl with protection (transparent upon request)

Code
FR10STP

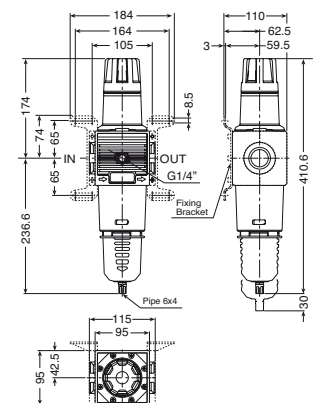
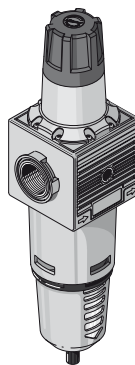

3 way on-off Valve - G1/4

Input P_{max}	12.5 bar
Temperature range:	5 - 50°C
Q_{rit} ($p=6.3$ bar):	950 NI/min
Exhaust port connection:	G1/8

Padlock included.

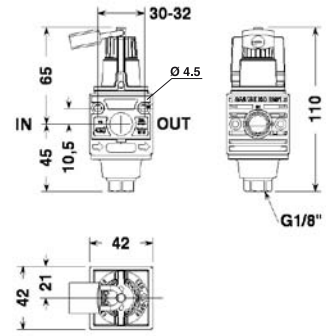

Code	VSB4ST
------	--------

3 way on-off Valve - G3/8

Input P_{max}	12.5 bar
Temperature range:	5 - 50°C
Q_{rit} ($p=6.3$ bar):	1600 NI/min
Exhaust port connection:	G1/4

Padlock included

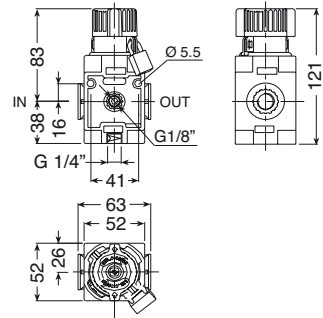
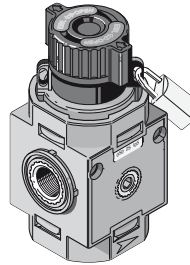

Code	VSB3ST
------	--------

3 way on-off Valve - G1/2

Input P_{max}	12.5 bar
Temperature range:	5 - 50°C
Q_{rit} ($p=6.3$ bar):	2000 NI/min
Exhaust port connection:	G1/4

Padlock included

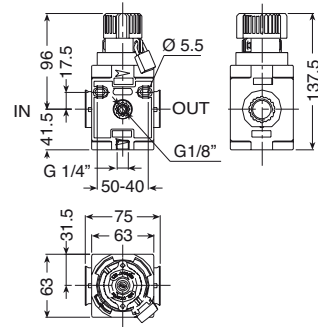
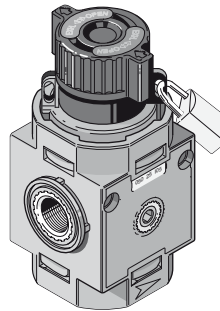

Code	VSB2ST
------	--------

3 way on-off Valve - G3/4

Input P_{max}	12.5 bar
Temperature range:	5 - 50°C
Q_{rit} ($p=6.3$ bar):	2000 NI/min
Exhaust port connection:	G1/4

Padlock included

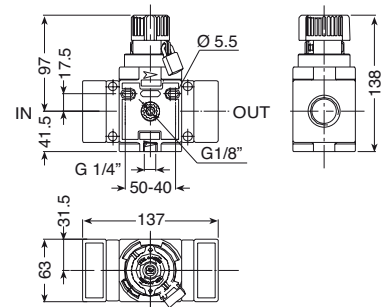
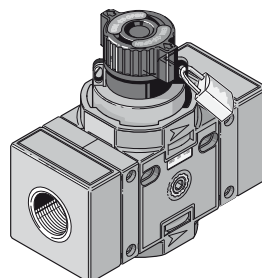

Code	VSB34ST
------	---------

ACCESSORIES
AIR TREATMENT UNITS

Shut-off Valve - G1/4

Max. pressure available:	10 bar
Min. pressure permitted:	3 bar
Temperature range:	5 - 50°C
Q_{ref} (p=6.3 bar):	900 NI/min
Exhaust port connection:	G1/8

Ready for Cnomo pilot (76.136.21.00)

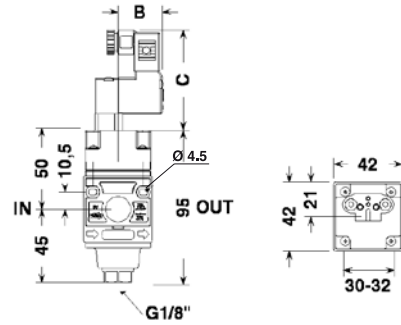
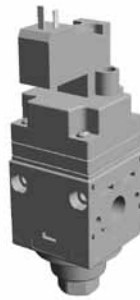

Code
VEC4ST

Shut-off Valve - G3/8

Max. pressure available:	10 bar
Min. pressure permitted:	3 bar
Temperature range:	5 - 50°C
Q_{ref} (p=6.3 bar):	2000 NI/min
Exhaust port connection:	G1/4

Ready for Cnomo pilot (76.136.21.00)

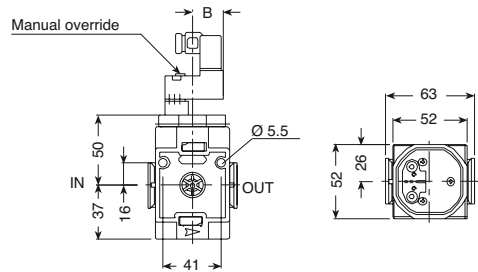
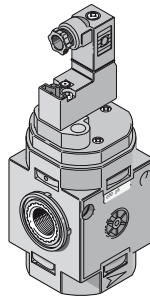

Code
VEC3ST

Shut-off Valve - G1/2

Max. pressure available:	10 bar
Min. pressure permitted:	3 bar
Temperature range:	5 - 50°C
Q_{ref} (p=6.3 bar):	2000 NI/min
Exhaust port connection:	G1/4

Ready for Cnomo pilot (76.136.21.00)

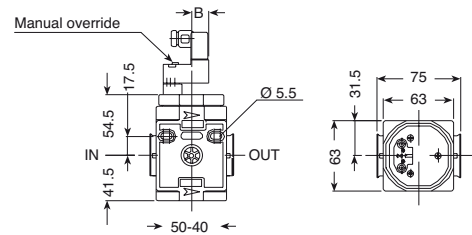
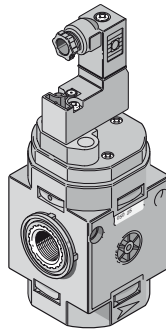

Code
VEC2ST

Shut-off Valve - G3/4

Max. pressure available:	10 bar
Min. pressure permitted:	3 bar
Temperature range:	5 - 50°C
Q_{ref} (p=6.3 bar):	2000 NI/min
Exhaust port connection:	G1/4

Ready for Cnomo pilot (76.136.21.00)

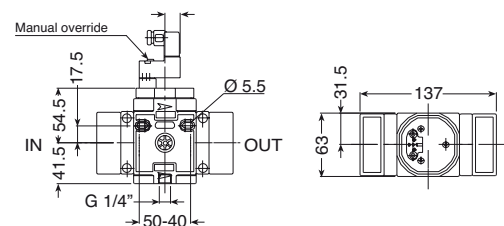
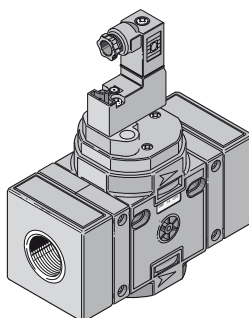

Code
VEC34ST

Slow Start Valve - G1/4

Max. pressure available:	10 bar
Min. pressure permitted:	3 bar
Temperature range:	5 - 50°C
Q_{ref} (p=6.3 bar):	900 NI/min

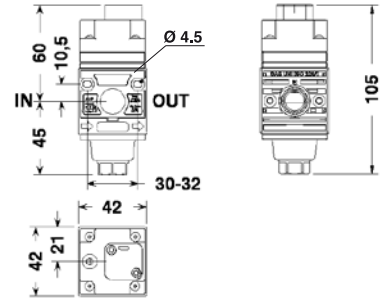
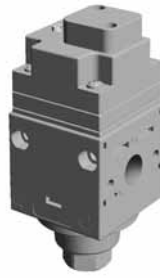

Code
AVP4ST

Slow Start Valve - G3/8

Max. pressure available:	10 bar
Min. pressure permitted:	3 bar
Temperature range:	5 - 50°C
Q_{ref} (p=6.3 bar):	1500 NI/min

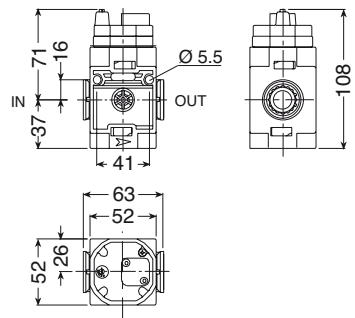
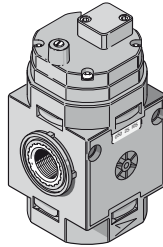

Code
AVP3ST

Slow Start Valve - G1/2

Max. pressure available:	10 bar
Min. pressure permitted:	3 bar
Temperature range:	5 - 50°C
Q_{ref} (p=6.3 bar):	2000 NI/min

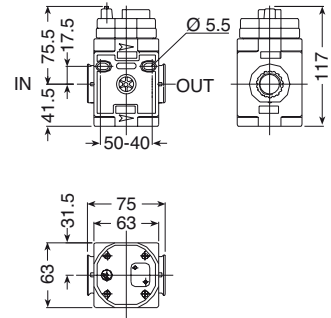
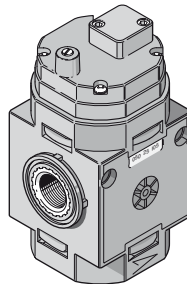

Code
AVP2ST

Slow Start Valve - G3/4

Max. pressure available:	10 bar
Min. pressure permitted:	3 bar
Temperature range:	5 - 50°C
Q_{ref} (p=6.3 bar):	2000 NI/min

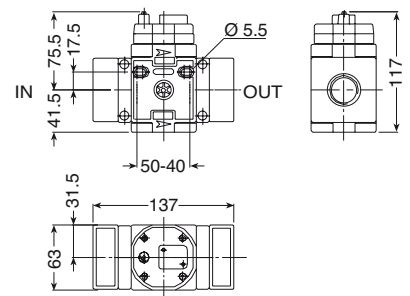
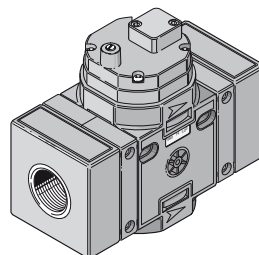

Code
AVP34ST

ACCESSORIES
AIR TREATMENT UNITS

Micro-regulator and Precision Micro-regulator

Diaphragm function

Relieving version

Input P_{max} :	16 bar
Pressure regulation range:	0 - 8 bar (standard) 0 - 4 bar
Temperature range:	5 - 50°C
Pressure connection:	G1/8, G1/4

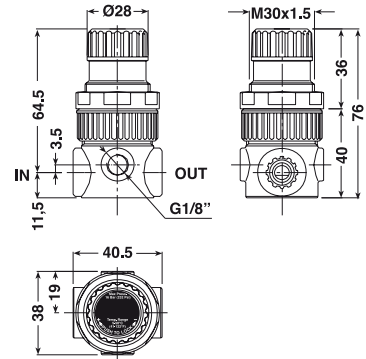
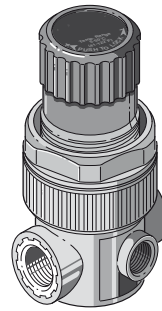

Code	Press. Conn.	Bar	Version
MR118ST	G1/8	0 - 8	Standard
MR114ST	G1/4	0 - 8	Standard
MR118ST4	G1/8	0 - 4	Standard
MR114ST4	G1/4	0 - 4	Standard
MR118STRFA	G1/8	0 - 8	Precision
MR114STRFA	G1/4	0 - 8	Precision

Oil Remover - Silencer

Material:	Filtering element in coalescent glass fiber
Temperature range:	2 - 50°C
Pressure connection:	G1/2, G1, G1 1/2
Q_{ref} ($p=7$ bar):	1500 NI/min (G1/2)
Q_{ref} ($p=7$ bar):	3000 NI/min (G1)
Q_{ref} ($p=7$ bar):	9000 NI/min (G1 1/2)

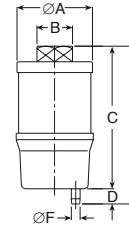

Code	Press. Conn.	A	B	C	D	E	F
CX25	G1/2	61	28	113	12	125	6
CX50	G1	61	40	161	12	173	6
CX150	G1 1/2	86	55	205	12	217	6

Note: Collection cup with drain oil.

Unit Assembly Kit

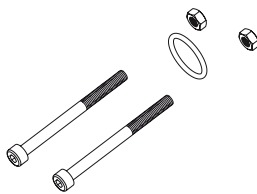

Code	Press. Conn.	Group
C400500001	G1/4	F+R+L
C400600001	G1/4	FR+L
C400700001	G1/4	F+L

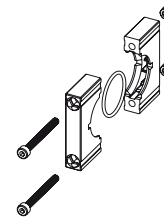

Code	Press. Conn.	Group
C500500001	G3/8	F+R+L
C500600001	G3/8	FR+L or F+L

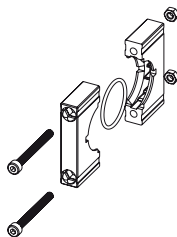

Code	Press. Conn.	Group
C750500001	G1/2	F+R+L
C750600001	G1/2	FR+L or F+L

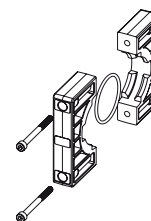

Code	Press. Conn.	Group
C950500001	G1	F+R+L
C950600001	G1	FR+L or F+L

Pressure Gauge Stainless Steel - Back Mount

Material: Stainless steel body, brass connection

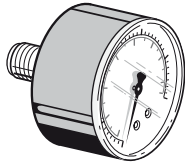

Code	Press. Conn.	Diameter	Pressure range
M4P806	1/8	40	0 - 6 bar
M4P812	1/8	40	0 - 12 bar
M5P806	1/8	50	0 - 6 bar
M5P812	1/8	50	0 - 12 bar
M6P406	1/4	63	0 - 6 bar
M6P412	1/4	63	0 - 12 bar

Pressure Gauge Stainless Steel - Flanged

Material: Stainless steel body, brass connection

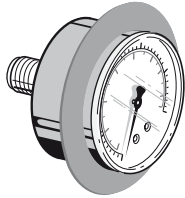

Code	Press. Conn.	Diameter	Pressure range
M4F806	1/8	40	0 - 6 bar
M4F812	1/8	40	0 - 12 bar
M5F806	1/8	50	0 - 6 bar
M5F812	1/8	50	0 - 12 bar
M6F406	1/4	63	0 - 6 bar
M6F412	1/4	63	0 - 12 bar

Pressure Gauge ABS - Back Mount

Material: ABS body, brass connection

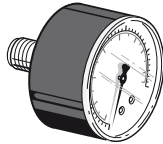

Code	Press. Conn.	Diameter	Pressure range
M4P806W	1/8	40	0 - 6 bar
M4P812W	1/8	40	0 - 12 bar
M5P806W	1/8	50	0 - 6 bar
M5P812W	1/8	50	0 - 12 bar
M6P406W	1/4	63	0 - 6 bar
M6P412W	1/4	63	0 - 12 bar

Mounting Bracket for Pressure Gauge

Material: Aluminium

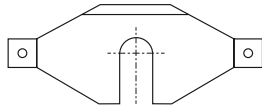

Code	Diameter
S4	40
S5	50
S6	63

Wall Bracket for Air Units

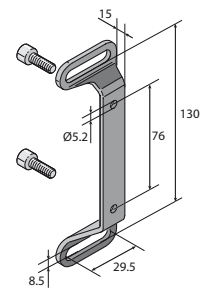
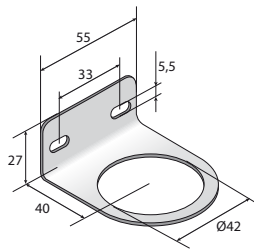
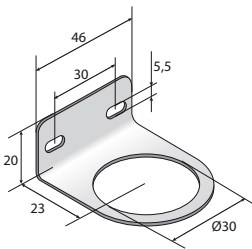

Code	Press. Conn.
SQP	G1/4

Code	Press. Conn.
SQM	G3/8-G1/2-G3/4

Code	Press. Conn.
SQG	G1

Automatic Drain & Assembly Kit

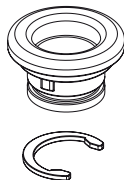
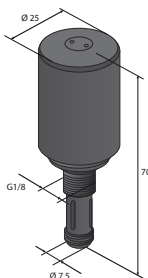

Code	Type
C400200130	Automatic Drain
C400200131	Assembly Kit for Automatic Drain

BSG PNEUMATIC ACCESSORIES VALVES & ACCESSORIES

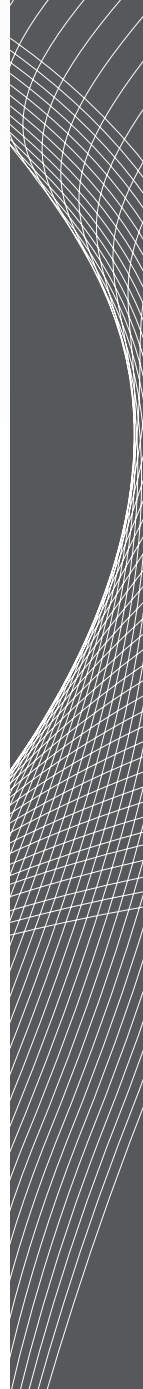
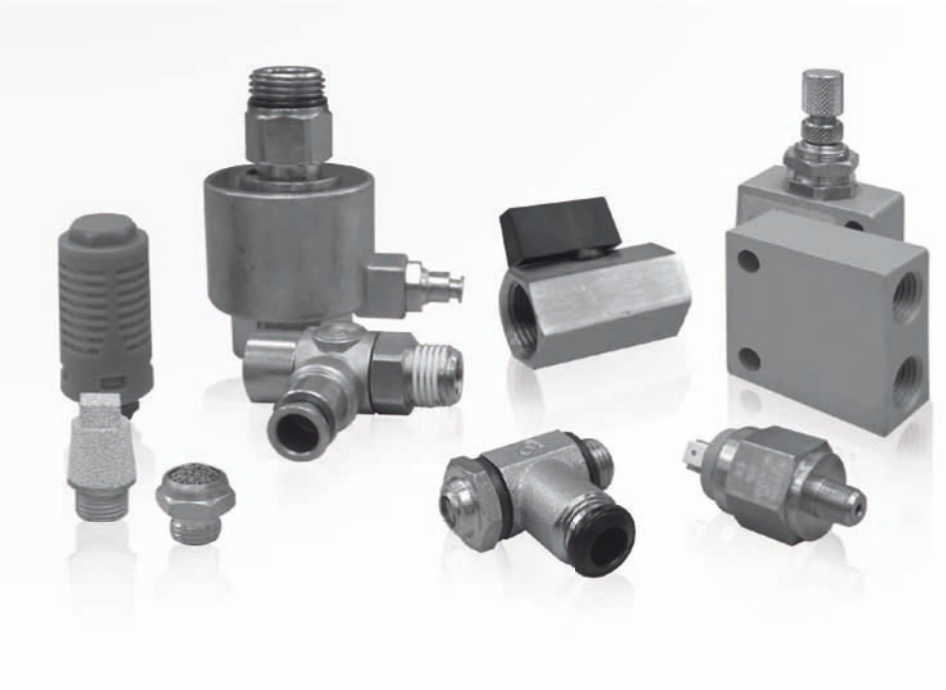

Silencer with Stainless Steel Wire

Maximum pressure:	12 bar
Temperature range:	-10°C ... + 80°C
Porosity:	0.6
Filtration threshold:	50 micron
Acoustic fading at 6 bar:	27 dB
Body:	Brass
Thread:	Stainless steel

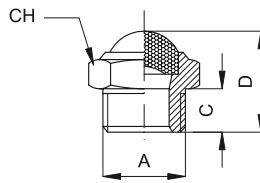

Code	A	CH	C	D
SR05	M5	3.5	8	8
SR08	1/8	13	6	15
SR04	1/4	16	7	18
SR03	3/8	19	8	20
SR02	1/2	24	10	22

Silencer

Body:	Brass
Thread:	Sintered bronze

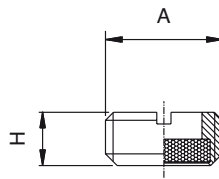

Code	A	H
SP08	1/8	5
SP04	1/4	6
SP03	3/8	7
SP02	1/2	8

Sintered Silencer

Body:	Nickel plated brass
Thread:	Sintered bronze

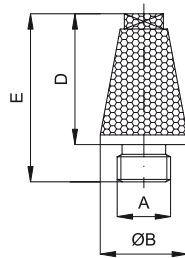

Code	A	E	ØB	D
SB05	M5	13	6	8.5
SB08	1/8	21	12	15
SB04	1/4	25	15	19
SB03	3/8	38	19	30
SB02	1/2	43	23	33

Nylon Silencer (Dynamic)

Body:	Acetalic resin
-------	----------------

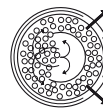
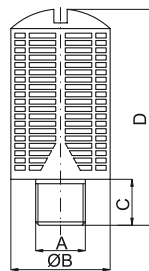

Code	A	ØB	C	D
SN08	1/8	15	6	32.5
SN04	1/4	19.5	8	43
SN03	3/8	24.5	11	58
SN02	1/2	24.5	11	58

Nylon Silencer (Static)

Body:	Acetalic resin
-------	----------------

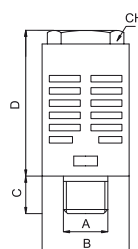

Code	A	B	C	D	CH
SN08P	1/8	15	6	26.5	12
SN04P	1/4	19.5	8	35	12
SN03P	3/8	24.5	11	47	17
SN02P	1/2	24.5	11	47	17

Compact Exhaust Regulator

Pressure: 0 - 10 bar
Temperature range: -20°C, +70°C
Body: Nickel plated brass

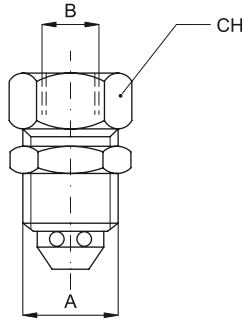

Code	A	B	CH
DSN08	1/8	1/8	12
DSN04	1/4	1/8	16

Compact Exhaust Regulator with Silencer

Pressure: 0 - 10 bar
Temperature range: -20°C, +70°C
Body: Brass
Filter: Sintered bronze

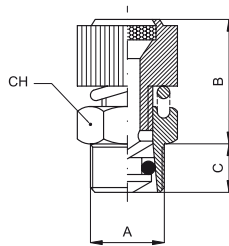

Code	A	B _{MIN}	B _{MAX}	C	CH
DSN08W	1/8	14	19	6	12
DSN04W	1/4	17	22	8	15
DSN02W	1/2	18	24	10.5	22

Exhaust Regulator with Silencer

Pressure: 0 - 10 bar
Temperature range: -20°C, +70°C
Body: Brass
Filter: Sintered bronze

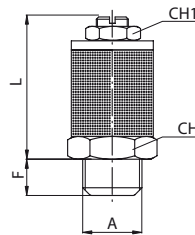

Code	A	L	F	CH1	CH
DSN05M	M5	18	3.5	6	8
DSN08M	1/8	36	8	10	16
DSN04M	1/4	36	9	10	16
DSN03M	3/8	50	10	10	22
DSN02M	1/2	50	11	10	22

Flow Regulator

Pressure: 2 - 10 bar
Temperature range: -10°C, +60°C
Body: Anodised aluminum
Seals: NBR
Pressure connection: G1/8, G1/4, G3/8, G1/2
Q_{nom} (p=6 bar) See order code table

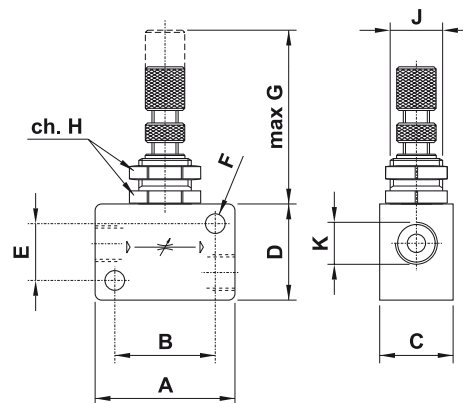

Code (one-way)	Code (two-way)	A	B	C	D	E	F	G	H	J	K	Q _{nom}
RFU08	RFB08	32	23	16.8	22	13	4.5	35	15	M12x0.75	1/8	450
RFU04	RFB04	40	30	22	32	22	4.5	35	15	M12x0.75	1/4	600
RFU03	RFB03	56	43	27	42	27	6.5	43	24	M18x1	3/8	1100
RFU02	RFB02	56	43	27	42	27	6.5	43	24	M18x1	1/2	1400

One-way Flow Regulator - Manual Regulation (series 8958N)

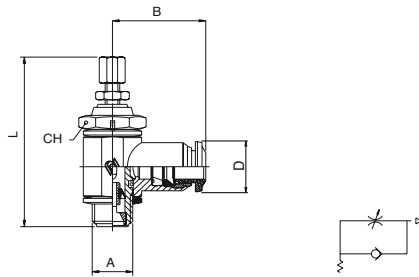

Code	Hose	A	B	L_{min}	L_{max}	CH
8958N.03.05	3	M5	19	33	37.5	8
8958N.04.05	4	M5	19	33	37.5	8
8958N.04.10	4	1/8	21	41	46.5	14
8958N.05.05	5	M5	20	33	37.5	8
8958N.05.10	5	1/8	21.5	41	46.5	14
8958N.05.13	5	1/4	24.5	46.5	52.5	17
8958N.06.05	6	M5	20.5	33	37.5	8
8958N.06.10	6	1/8	22.5	41	46.5	14
8958N.06.13	6	1/4	25	46.5	52.5	17
8958N.08.10	8	1/8	24	41	46.5	14
8958N.08.13	8	1/4	26	46.5	52.5	17

One-way Flow Regulator - Manual Regulation (series 8968N)

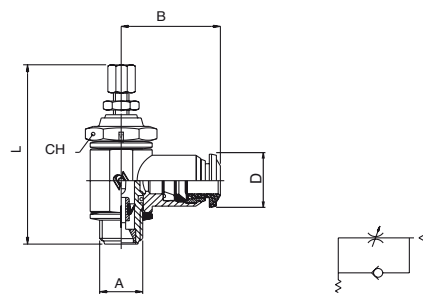

Code	Hose	A	B	L_{min}	L_{max}	CH
8968N.0305	3	M5	19	33	37.5	8
8968N.0405	4	M5	19	33	37.5	8
8968N.0410	4	1/8	21	41	46.5	14
8968N.0505	5	M5	20	33	37.5	8
8968N.0510	5	1/8	21.5	41	46.5	14
8968N.0513	5	1/4	24.5	46.5	52.5	17
8968N.0605	6	M5	20.5	33	37.5	8
8968N.0610	6	1/8	22.5	41	46.5	14
8968N.0613	6	1/4	25	46.5	52.5	17
8968N.0810	8	1/8	24	41	46.5	14
8968N.0813	8	1/4	26	46.5	52.5	17

Two-way Flow Regulator - Manual Regulation (series 8978N)

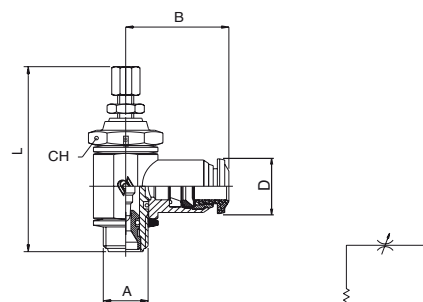

Code	Hose	A	B	L_{min}	L_{max}	CH
8978N.0305	3	M5	19	33	37.5	8
8978N.0405	4	M5	19	33	37.5	8
8978N.0410	4	1/8	21	41	46.5	14
8978N.0505	5	M5	20	33	37.5	8
8978N.0510	5	1/8	21.5	41	46.5	14
8978N.0513	5	1/4	24.5	46.5	52.5	17
8978N.0605	6	M5	20.5	33	37.5	8
8978N.0610	6	1/8	22.5	41	46.5	14
8978N.0613	6	1/4	25	46.5	52.5	17
8978N.0810	8	1/8	24	41	46.5	14
8978N.0813	8	1/4	26	46.5	52.5	17

One-way Flow Regulator - Screwdriver Regulation (series 8953N)

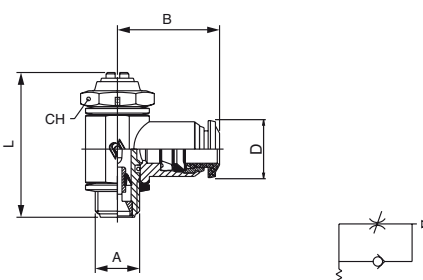

Code	Hose	A	B	L	CH
8953N.03.05	3	M5	19	24	8
8953N.04.05	4	M5	19	24	8
8953N.04.10	4	1/8	21	30.5	14
8953N.05.05	5	M5	20	24	8
8953N.05.10	5	1/8	21.5	30.5	14
8953N.05.13	5	1/4	24.5	35.5	17
8953N.06.05	6	M5	20.5	24	8
8953N.06.10	6	1/8	22.5	30.5	14
8953N.06.13	6	1/4	25	35.5	17
8953N.08.10	8	1/8	24	30.5	14
8953N.08.13	8	1/4	26	35.5	17

One-way Flow Regulator for Valve - Screwdriver Regulation (series 8963N)

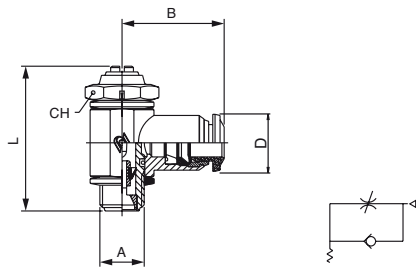

Code	Hose	A	B	L	CH
8963N.03.05	3	M5	19	24	8
8963N.04.05	4	M5	19	24	8
8963N.04.10	4	1/8	21	30.5	14
8963N.05.05	5	M5	20	24	8
8963N.05.10	5	1/8	21.5	30.5	14
8963N.05.13	5	1/4	24.5	35.5	17
8963N.06.05	6	M5	20.5	24	8
8963N.06.10	6	1/8	22.5	30.5	14
8963N.06.13	6	1/4	25	35.5	14
8963N.08.10	8	1/8	24	30.5	14
8963N.08.13	8	1/4	26	35.5	17

Two-way Flow Regulator - Screwdriver Regulation (series 8973N)

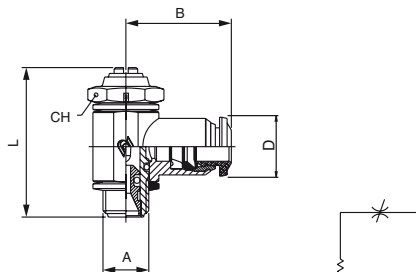

Code	Hose	A	B	L	CH
8973N.03.05	3	M5	19	24	8
8973N.04.05	4	M5	19	24	8
8973N.04.10	4	1/8	21	30.5	14
8973N.05.05	5	M5	20	24	8
8973N.05.10	5	1/8	21.5	30.5	14
8973N.05.13	5	1/4	24.5	35.5	17
8973N.06.05	6	M5	20.5	24	8
8973N.06.10	6	1/8	22.5	30.5	14
8973N.06.13	6	1/4	25	35.5	17
8973N.08.10	8	1/8	24	30.5	14
8973N.08.13	8	1/4	26	35.5	17

PE Converter (with diaphragm)

- Max Static Pressure:** 80 bar
- Regulation range:** 1 - 10 bar
- Tolerance at 20 ° C:** ± 0.5 bar
- Max voltage switchable:** 48 V
- Max Fluid Temperature:** +80°C
- Body:** Brass
- Protection grade:** IP54 with CAP1
- Pressure Connection:** G 1/8

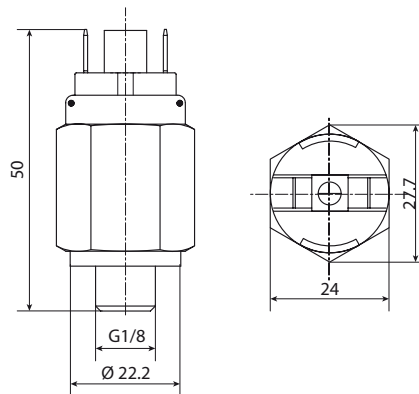

Code	Press. Conn.
PM10A	NA
PM10C	NC

Protective Cap for PE Converter

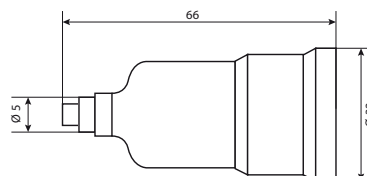

Code
CAP1

ACCESSORIES VALVES & ACCESSORIES

Non Return Valve (female - female)

Pressure: 2 - 8 bar
Temperature range: -18°C, +70°C
Body: Nickel plated brass

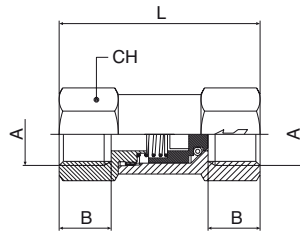

Code	A	B	L	CH
VU05	M5	5.5	26.5	8
VU08	1/8	8.5	35.5	13
VU04	1/4	11	43	17
VU03	3/8	12	58	24
VU02	1/2	15	63	24

Sleeve Valve

Pressure: 2 - 8 bar
Temperature range: -18°C, +70°C
Body: Nickel plated brass
Sleeve: Anodised aluminum
Seal: NBR

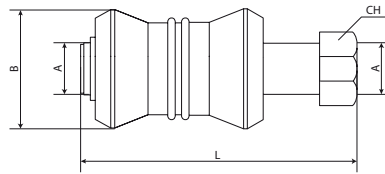

Code	A	B	L	CH
VM08	1/8	25	48	14
VM04	1/4	30	58	17
VM03	3/8	35	70	22
VM02	1/2	40	80	26

Quick Exhaust Valve

Pressure: 0.3 - 10 bar
Temperature range: -18°C, +70°C

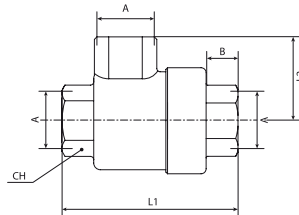

Code	A	B	L1	L2	CH
VSR08	1/8	8.5	42	19.5	15
VSR04	1/4	11	54	25	19
VSR02	1/2	15	72	32	26
VSR03	3/8	12	60.5	26.5	22
VSR34	3/4	18.5	88	37	32
VSR10	1	19	109	48	46

Mini Ball Valve

Pressure: 0 - 10 bar
Temperature range: -25°C, +90°C
Body: Nickel plated brass
Seals: NBR

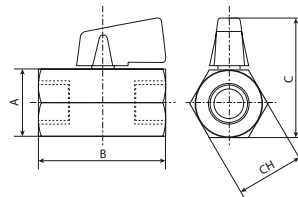

Code	A	B	C	CH
VMB08	1/8	39	38	21
VMB04	1/4	40	38	21
VMB03	3/8	42	38	21
VMB02	1/2	48	42	25

Ball Valve

Pressure: Up to 50 bar
Temperature range: -20°C, +130°C
Body: Cast iron

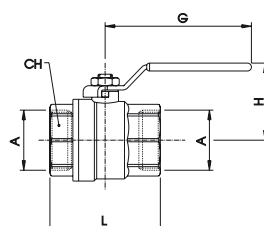

Code	A	L	G	H	CH
VKS04	1/4	41	75	50	18
VKS03	3/8	46	70	50	21
VKS02	1/2	55	96	57	26

Selector Valve (OR)

Pressure:	2 - 10 bar
Temperature range:	-10°C, +60°C
Body:	Anodised aluminum
Seals:	NBR
Pressure connection:	G1/8, G1/4

VOR08

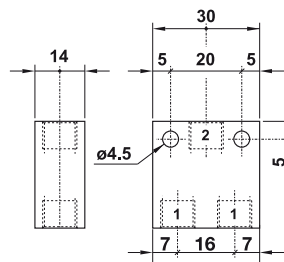

VOR04

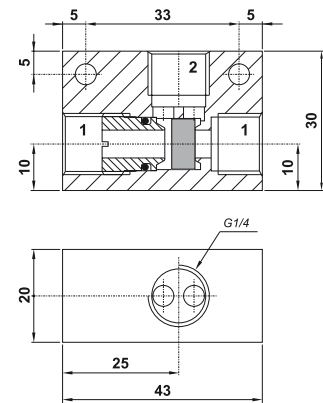

Code	Press. Conn.
VOR08	G 1/8
VOR04	G 1/4

Logic Valve (AND)

Pressure:	2 - 10 bar
Temperature range:	-10°C, +60°C
Body:	Anodised aluminum
Seals:	NBR
Pressure connection:	G1/8

VAND08

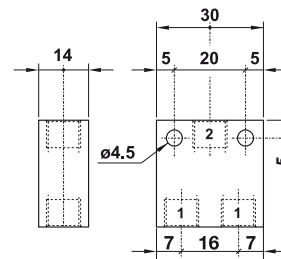

Code
VAND08

Blocking Valve

Max. pressure available:	10 bar (one-way valve - series V6) 8 bar (two-way valve - series V7)
Min. control pressure:	4.5 bar (one-way valve - series V6) 2 bar (two-way valve - series V7)
Temperature range:	-10°C, +80°C
Body:	Brass with zamak coating
Seals:	NBR

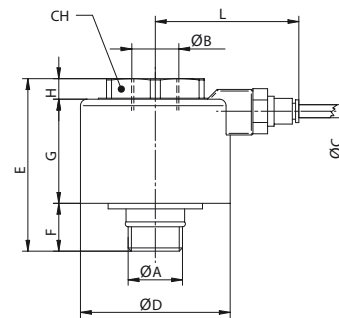

Pressure Connection	Ordercode (one-way)	Ordercode (two-way)
G 1/8	V718800	V618800
G 1/4	V714400	V614400
G 3/8	V713300	V613300
G 1/2	V712201	V612201

Type	Symbol
One-way	
Two-way	

A	B	C	D	E	F	G	H	L	L1	CH	Ø	Q (Nl/min)
1/8	1/8	4	30	30	9	21	6	29	27	17	5	800
1/4	1/4	4	36	38	12	26	6	33	29	22	7.5	1900
3/8	3/8	4	46	47	14	33	6	36	33	30	9	2500
1/2	1/2	4	46	56	23	33	14	36	33	30	9	2500

ACCESSORIES VALVES & ACCESSORIES

BSG PNEUMATIC ACCESSORIES
TUBING

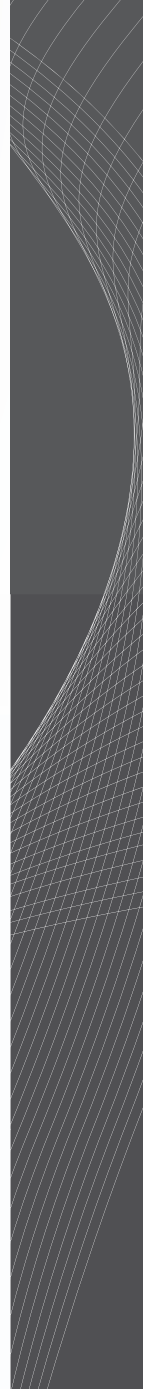

TUBING

General Information

Ambient temperature range:	From -40 °C to +80 °C (for rilsan PA11 hoses) From -40 °C to +60 °C (for polyethylene and polyurethane hoses)
Max. Pressure available:	See order code table
Materials:	Rilsan PA11 Polyethylene Polyurethane

Rilsan PA11 Tubing

The table indicates the change of pressure (in %) as a function of temperature

Temperature	20°C	30°C	40°C	50°C	70°C	80°C
Pressure change	100%	83%	72%	64%	52%	47%

Polyethylene and Polyurethane Tubing

The table indicates the change of pressure (in %) as a function of temperature

Temperature	20°C	30°C	40°C	50°C	60°C
Pressure change	100%	83%	72%	64%	57%

Flexible Hoses (Rilsan PA11)

Dimension		Lenght	Weight	Rad. Curv.	Pressure	Code						
<i>d_{ext}</i>	<i>d_{int}</i>	<i>m</i>	<i>kg/100m</i>	<i>mm</i>	<i>Kg/cm²</i>	Neutral	Red	Yellow	Blue	Green	Black	Light Blue
2	1	100	0.26	10	64.68	TR02	TR02R	TR02G	TR02B	TR02V	TR02N	TR02A
3	1.5	100	0.56	15	28.42	TR025	TR025R	TR025G	TR025B	TR025V	TR025N	TR025A
3	2	100	0.45	15	24.50	TR022	TR022R	TR022G	TR022B	TR022V	TR022N	TR022A
4	2	100	1	20	64.68	TR04	TR04R	TR04G	TR04B	TR04V	TR04N	TR04A
4	2.5	100	0.78	20	45.08	TR045	TR045R	TR045G	TR045B	TR045V	TR045N	TR045A
4	2.7	100	0.72	25	35.28	TR047	TR047R	TR047G	TR047B	TR047V	TR047N	TR047A
4	3	100	0.6	25	27.44	TR043	TR043R	TR043G	TR043B	TR043V	TR043N	TR043A
5	3	100	1.35	25	49.00	TR053	TR053R	TR053G	TR053B	TR053V	TR053N	TR053A
5	3.5	100	1.005	30	35.28	TR055	TR055R	TR055G	TR055B	TR055V	TR055N	TR055A
6	3.5	100	1.9	30	51.94	TR065	TR065R	TR065G	TR065B	TR065V	TR065N	TR065A
6	4	100	1.65	35	39.20	TR06	TR06R	TR06G	TR06B	TR06V	TR06N	TR06A
7	5	100	1.95	38	32.34	TR075	TR075R	TR075G	TR075B	TR075V	TR075N	TR075A
8	5	100	3.2	40	45.08	TR085	TR085R	TR085G	TR085B	TR085V	TR085N	TR085A
8	6	100	2.34	40	28.42	TR08	TR08R	TR08G	TR08B	TR08V	TR08N	TR08A
9	7	100	2.7	55	24.50	TR097	TR097R	TR097G	TR097B	TR097V	TR097N	TR097A
10	6	100	5.2	60	47.04	TR106	TR106R	TR106G	TR106B	TR106V	TR106N	TR106A
10	6.5	100	4.8	60	39.20	TR105	TR105R	TR105G	TR105B	TR105V	TR105N	TR105A
10	7	100	4.24	60	34.30	TR107	TR107R	TR107G	TR107B	TR107V	TR107N	TR107A
10	8	100	2.98	60	17.64	TR10	TR10R	TR10G	TR10B	TR10V	TR10N	TR10A
12	8	100	6.41	60	39.20	TR128	TR128R	TR128G	TR128B	TR128V	TR128N	TR128A
12	9	100	5.25	70	24.50	TR129	TR129R	TR129G	TR129B	TR129V	TR129N	TR129A
12	10	100	3.66	85	16.66	TR12	TR12R	TR12G	TR12B	TR12V	TR12N	TR12A
14	10	100	7.8	80	31.36	TR140	-	-	-	-	-	-
14	11	100	6.2	85	23.52	TR141	-	-	-	-	-	-
14	12	100	4.3	90	14.70	TR142	-	-	-	-	-	-
15	12	100	6.7	90	19.60	TR15	-	-	-	-	-	-
15	13	100	4.85	95	11.76	TR153	-	-	-	-	-	-
16	12	100	9.3	95	23.52	TR162	-	-	-	-	-	-
16	14	100	5	100	10.78	TR164	-	-	-	-	-	-
18	14	100	10.6	100	21.56	TR184	-	-	-	-	-	-
18	15	100	8.3	140	15.68	TR185	-	-	-	-	-	-
18	16	100	5.6	350	9.80	TR186	-	-	-	-	-	-
20	16	100	12	130	19.60	TR206	-	-	-	-	-	-
20	18	100	6.4	400	8.82	TR208	-	-	-	-	-	-
22	18	100	13.3	200	17.64	TR228	-	-	-	-	-	-
22	19	100	10.4	250	12.74	TR229	-	-	-	-	-	-
22	20	100	7	400	7.84	TR220	-	-	-	-	-	-
24	20	100	14.6	300	15.68	TR240	-	-	-	-	-	-
25	22	100	11.8	300	11.76	TR252	-	-	-	-	-	-

Spiral Hoses

Dimension		Lenght	Spiral		Diameter		Code		
<i>d_{ext}</i>	<i>d_{int}</i>	<i>m</i>	<i>at rest</i>	<i>max. extension</i>	<i>int</i>	<i>ext</i>	Blue	Orange	White
4	2	10	0.46	6.5	20	28	-	-	STR04
6	4	30	0.95	20	55	67	STR06B	STR06	-
8	6	30	1	20	70	86	STR08B	STR08	-
10	8	30	1	20	90	120	STR10B	STR10	-
12	10	30	1	20	110	134	STR12B	STR12	-

Flexible Hoses (Polyethylene)

Dimension		Lenght	Weight	Rad. Curv.	Pressure	Code						
d_{ext}	d_{int}	m	kg/100m	mm	Kg/cm ²	Neutral	Red	Yellow	Blue	Green	Black	Light Blue
2	1	100	0.23	10	30	PE02	PE02R	PE02G	PE02B	PE02V	PE02N	PE02A
2.5	1.5	100	0.3	15	15	PE025	PE025R	PE025G	PE025B	PE025V	PE025N	PE025A
3	1.5	100	0.5	15	20	PE035	PE035R	PE035G	PE035B	PE035V	PE035N	PE035A
4	2	100	0.91	18	30	PE04	PE04R	PE04G	PE04B	PE04V	PE04N	PE04A
4	2.5	100	0.73	20	20	PE045	PE045R	PE045G	PE045B	PE045V	PE045N	PE045A
4	3	100	0.52	22	10	PE043	PE043R	PE043G	PE043B	PE043V	PE043N	PE043A
5	3	100	1.2	25	25	PE053	PE053R	PE053G	PE053B	PE053V	PE053N	PE053A
6	3.5	100	1.8	25	26	PE065	PE065R	PE065G	PE065B	PE065V	PE065N	PE065A
6	4	100	1.5	30	20	PE065	PE06R	PE06G	PE06B	PE06V	PE06N	PE06A
7	5	100	1.8	35	16	PE075	PE075R	PE075G	PE075B	PE075V	PE075N	PE075A
8	4	100	3.6	35	40	PE84	PE84R	PE84G	PE84B	PE84V	PE84N	PE84A
8	5	100	3	40	23	PE085	PE085R	PE085G	PE085B	PE085V	PE085N	PE085A
8	6	100	2.11	40	14	PE085	PE08R	PE08G	PE08B	PE08V	PE08N	PE08A
9	7	100	2.42	45	12	PE097	PE097R	PE097G	PE097B	PE097V	PE097N	PE097A
10	6	100	4.8	55	30	PE106	PE106R	PE106G	PE106B	PE106V	PE106N	PE106A
10	6.5	100	4.35	60	20	PE105	PE105R	PE105G	PE105B	PE105V	PE105N	PE105A
10	7	100	3.85	60	20	PE107	PE107R	PE107G	PE107B	PE107V	PE107N	PE107A
10	8	100	2.71	60	9	PE10	PE10R	PE10G	PE10B	PE10V	PE10N	PE10A
12	8	100	6	60	20	PE128	PE128R	PE128G	PE128B	PE128V	PE128N	PE128A
12	9	100	4.75	65	12	PE129	PE129R	PE129G	PE129B	PE129V	PE129N	PE129A
12	10	100	3.3	80	7.5	PE12	PE12R	PE12G	PE12B	PE12V	PE12N	PE12A
14	10	100	7.2	80	16	PE140	-	-	-	-	-	-
14	11	100	5.65	80	12	PE141	-	-	-	-	-	-
15	12	100	6.1	85	10	PE152	-	-	-	-	-	-
15	12.5	100	5.2	100	8	PE155	-	-	-	-	-	-
16	12	100	8.4	100	12	PE162	-	-	-	-	-	-
18	10	100	16.8	105	28	PE180	-	-	-	-	-	-
18	14	100	9.65	120	12	PE184	-	-	-	-	-	-
20	14	100	15.4	130	15	PE204	-	-	-	-	-	-
20	15	100	13.2	140	12	PE205	-	-	-	-	-	-
20	16	100	10.8	150	10	PE206	-	-	-	-	-	-
25	18	100	22.7	180	14	PE258	-	-	-	-	-	-
26	20	100	20.8	200	12	PE260	-	-	-	-	-	-
25	21	100	13.9	250	8	PE251	-	-	-	-	-	-
26	22	100	14.5	260	7	PE262	-	-	-	-	-	-
32	25	100	30	290	10	PE325	-	-	-	-	-	-
32	26	100	26	300	8	PE326	-	-	-	-	-	-

Polyurethane hoses

Dimension		Lenght	Weight	Rad. Curv.	Pressure	Code		
d_{ext}	d_{int}	m	kg/100m	mm	Kg/cm ²	Neutral	Light Blue	Black
3	1.5	100	0.65	15	18	TX03	TX03A	TX03N
4	2	100	1.08	20	20	TX04	TX04A	TX04N
4	2.5	100	0.88	20	15	TX0425	TX0425A	TX0425N
6	4	100	1.9	30	10	TX06	TX06A	TX06N
8	6	100	2.9	35	8.5	TX08	TX08A	TX08N

Tube holder

Description: Tube holder rack for 10 tubes 5x1

Material: Polyethylene

Colour: Transparent

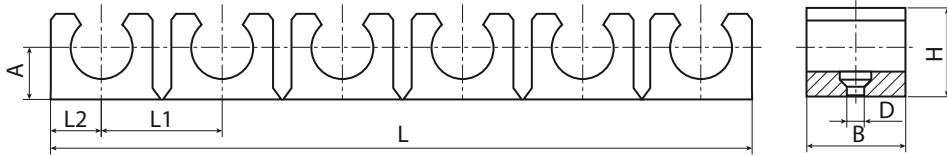

Code	A	B	D	H	L	L1	L2
SP.750.3923	6	14	2.4	9	100.4	10	5.2

Vinyl Tube Cutter

Description: Vinyl Tube Cutter for tubes 2 mm to 12 mm

Material: Plastic

Colour: Black

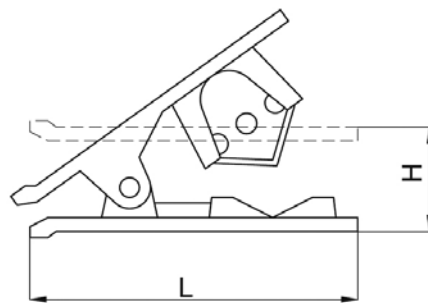

Code	H	L
PT01	6	14

PART No. INDEX

Part No. Index

CODE	ID	PAGE
50.001	55062	H - 18
50.002	55064	H - 18
50.007	12328	H - 12
50.008	12326	H - 12
50.009	12300	H - 17
50.010	55063	H - 18
50.021	12327	H - 12
50.029	55065	H - 18
50.030	11992	H - 16
50.033	12787	H - 17
50.034	12788	H - 17
50.036	12302	H - 14
50.040	16355	H - 14
50.045	12303	H - 14
50.046	12325	H - 12
50.050	12304	H - 16
50.051	12299	H - 17
50.052	52740	H - 16
50.053	12323	H - 16
50.054	52737	H - 16
50.056	11996	H - 14
50.062	11999	H - 14
50.063	12000	H - 14
50.064	12001	H - 14
50.065	12002	H - 14
50.100	12305	H - 16
50.120	52738	H - 17
50.121	12307	H - 13
50.122	52739	H - 17
50.123	12309	H - 13
50.124	12310	H - 17
50.130	12311	H - 12
50.140	12312	H - 13
50.150	51853	H - 13
50.170	12315	H - 12
50180	12316	H - 13
50.191	51605	H - 12
50.192	51606	H - 12
50.222	12003	H - 18
50.224	12004	H - 18
50.400	12318	H - 13
50.410	12319	H - 13
50.420	12477	H - 13
50.500	22756	H - 17
50.501	11989	H - 17
50.627	55972	H - 16
50.704	13030	H - 14
50.706	43647	H - 14
52.115	16471	H - 16
50.226.04	80393	H - 18
50020N.03.05	137884	H - 4
50020N.04.05	132447	H - 4
50020N.04.10	132448	H - 4
50020N.04.13	132449	H - 4
50020N.05.05	132450	H - 4
50020N.05.10	132451	H - 4
50020N.06.05	132452	H - 4

CODE	ID	PAGE
50020N.06.10	132453	H - 4
50020N.06.13	132454	H - 4
50020N.08.10	132455	H - 4
50020N.08.13	132456	H - 4
50020N.08.17	132457	H - 4
50020N.10.13	132458	H - 4
50020N.10.17	132459	H - 4
50020N.12.17	132460	H - 4
50020N.12.21	132461	H - 4
50020N.14.17	137889	H - 4
50020N.14.21	137890	H - 4
50030N.03.05	137891	H - 4
50030N.04.10	132462	H - 4
50030N.05.10	132463	H - 4
50030N.06.10	132464	H - 4
50030N.06.13	132465	H - 4
50030N.08.10	132466	H - 4
50030N.08.13	132467	H - 4
50040N.03.00	137893	H - 4
50040N.04.00	132468	H - 4
50040N.05.00	132469	H - 4
50040N.06.00	132470	H - 4
50040N.06.04	132471	H - 4
50040N.08.00	132472	H - 4
50040N.08.06	132473	H - 4
50040N.10.00	132474	H - 4
50040N.12.00	132475	H - 4
50040N.14.00	137894	H - 4
50050N.03.00	137895	H - 4
50050N.04.00	132476	H - 4
50050N.05.00	132477	H - 4
50050N.06.00	132478	H - 4
50050N.08.00	132479	H - 4
50050N.10.00	132480	H - 4
50050N.12.00	132481	H - 4
50116N.03.05	-	H - 5
50116N.04.05	132482	H - 5
50116N.04.10	132483	H - 5
50116N.04.13	-	H - 5
50116N.05.05	-	H - 5
50116N.05.10	-	H - 5
50116N.06.05	-	H - 5
50116N.06.10	-	H - 5
50116N.06.13	132489	H - 5
50116N.08.10	132490	H - 5
50116N.08.13	132491	H - 5
50116N.08.17	-	H - 5
50116N.08.21	-	H - 5
50116N.10.13	-	H - 5
50116N.10.17	132495	H - 5
50116N.10.21	-	H - 5
50116N.12.17	-	H - 5
50116N.12.21	-	H - 5
50116N.14.17	-	H - 5
50116N.14.21	-	H - 5
50126N.04.10	-	H - 5
50126N.04.13	-	H - 5

CODE	ID	PAGE
50020N.06.10	132453	H - 4
50020N.06.13	132454	H - 4
50020N.08.10	132455	H - 4
50020N.08.13	132456	H - 4
50020N.08.17	132457	H - 4
50020N.10.13	132458	H - 4
50020N.10.17	132459	H - 4
50020N.12.17	132460	H - 4
50020N.12.21	132461	H - 4
50020N.14.17	137889	H - 4
50020N.14.21	137890	H - 4
50030N.03.05	137891	H - 4
50030N.04.10	132462	H - 4
50030N.05.10	132463	H - 4
50030N.06.10	132464	H - 4
50030N.06.13	132465	H - 4
50030N.08.10	132466	H - 4
50030N.08.13	132467	H - 4
50040N.03.00	137893	H - 4
50040N.04.00	132468	H - 4
50040N.05.00	132469	H - 4
50040N.06.00	132470	H - 4
50040N.06.04	132471	H - 4
50040N.08.00	132472	H - 4
50040N.08.06	132473	H - 4
50040N.10.00	132474	H - 4
50040N.12.00	132475	H - 4
50040N.14.00	137894	H - 4
50050N.03.00	137895	H - 4
50050N.04.00	132476	H - 4
50050N.05.00	132477	H - 4
50050N.06.00	132478	H - 4
50050N.08.00	132479	H - 4
50050N.10.00	132480	H - 4
50050N.12.00	132481	H - 4
50116N.03.05	-	H - 5
50116N.04.05	132482	H - 5
50116N.04.10	132483	H - 5
50116N.04.13	-	H - 5
50116N.05.05	-	H - 5
50116N.05.10	-	H - 5
50116N.06.05	-	H - 5
50116N.06.10	-	H - 5
50116N.06.13	132489	H - 5
50116N.08.10	132490	H - 5
50116N.08.13	132491	H - 5
50116N.08.17	-	H - 5
50116N.08.21	-	H - 5
50116N.10.13	-	H - 5
50116N.10.17	132495	H - 5
50116N.10.21	-	H - 5
50116N.12.17	-	H - 5
50116N.12.21	-	H - 5
50116N.14.17	-	H - 5
50116N.14.21	-	H - 5
50126N.04.10	-	H - 5
50126N.04.13	-	H - 5

Part No. Index

CODE	ID	PAGE
50126N.05.10	-	H - 5
50126N.06.10	132502	H - 5
50126N.06.13	-	H - 5
50126N.08.10	-	H - 5
50126N.08.13	-	H - 5
50126N.08.17	-	H - 5
50126N.10.13	-	H - 5
50126N.10.17	-	H - 5
50130N.03.00	137940	H - 5
50130N.04.00	132509	H - 5
50130N.05.00	132510	H - 5
50130N.06.00	132511	H - 5
50130N.08.00	132512	H - 5
50130N.10.00	132513	H - 5
50130N.12.00	132514	H - 5
50130N.14.00	137941	H - 5
50216N.03.05	-	H - 6
50216N.04.05	-	H - 6
50216N.04.10	-	H - 6
50216N.04.13	-	H - 6
50216N.05.05	-	H - 6
50216N.05.10	-	H - 6
50216N.06.05	-	H - 6
50216N.06.10	-	H - 6
50216N.06.13	-	H - 6
50216N.08.10	-	H - 6
50216N.08.13	-	H - 6
50216N.10.13	-	H - 6
50216N.10.17	-	H - 6
50216N.10.21	-	H - 6
50216N.12.17	-	H - 6
50216N.12.21	-	H - 6
50216N.14.17	-	H - 6
50216N.14.21	-	H - 6
50226N.03.05	-	H - 6
50226N.04.05	-	H - 6
50226N.04.10	-	H - 6
50226N.04.13	-	H - 6
50226N.05.05	-	H - 6
50226N.05.10	-	H - 6
50226N.06.05	-	H - 6
50226N.06.10	-	H - 6
50226N.06.13	-	H - 6
50226N.08.10	-	H - 6
50226N.08.13	-	H - 6
50226N.10.13	-	H - 6
50226N.10.17	-	H - 6
50226N.10.21	-	H - 6
50226N.12.17	-	H - 6
50226N.12.21	-	H - 6
50230N.03.00	137991	H - 6
50230N.04.00	132545	H - 6
50230N.05.00	132546	H - 6
50230N.06.00	132547	H - 6
50230N.08.00	132548	H - 6
50230N.10.00	132549	H - 6
50230N.12.00	132550	H - 6
50230N.14.00	137992	H - 6
50310N.03.00	137994	H - 6
50310N.04.00	132551	H - 6
50310N.05.00	132552	H - 6
50310N.06.00	132553	H - 6

CODE	ID	PAGE
50310N.08.00	132554	H - 6
50500N.03.05	137996	H - 7
50500N.03.06	137997	H - 7
50500N.04.05	132555	H - 7
50500N.04.06	137998	H - 7
50500N.04.10	132556	H - 7
50500N.05.05	132557	H - 7
50500N.05.06	137999	H - 7
50500N.05.10	132558	H - 7
50500N.05.13	132559	H - 7
50500N.06.05	132560	H - 7
50500N.06.06	138000	H - 7
50500N.06.10	132561	H - 7
50500N.06.13	132562	H - 7
50500N.08.10	132563	H - 7
50500N.08.13	132564	H - 7
50500N.08.17	132565	H - 7
50500N.10.13	132566	H - 7
50500N.10.17	132567	H - 7
50500N.12.17	132568	H - 7
50510N.04.05	132569	H - 7
50510N.04.06	138009	H - 7
50510N.04.10	132570	H - 7
50510N.05.10	132571	H - 7
50510N.05.13	132572	H - 7
50510N.06.10	132573	H - 7
50510N.06.13	132574	H - 7
50510N.08.10	132575	H - 7
50510N.08.13	132576	H - 7
51410N.05.00	132606	H - 7
51410N.06.00	138028	H - 7
51410N.10.00	132607	H - 7
51410N.13.00	132608	H - 7
51410N.17.00	132609	H - 7
51420N.10.00	132610	H - 7
51420N.13.00	132611	H - 7
51420N.17.00	132612	H - 7
51430N.10.00	132613	H - 7
51430N.13.00	132614	H - 7
51430N.17.00	132615	H - 7
8953N.03.05	138375	H - 37
8953N.04.05	132692	H - 37
8953N.04.10	132693	H - 37
8953N.05.05	132694	H - 37
8953N.05.10	132695	H - 37
8953N.05.13	132696	H - 37
8953N.06.05	132697	H - 37
8953N.06.10	132698	H - 37
8953N.06.13	132699	H - 37
8953N.08.10	132700	H - 37
8953N.08.13	132701	H - 37
8958N.03.05	138377	H - 37
8958N.04.05	132702	H - 37
8958N.04.10	132703	H - 37
8958N.05.05	132704	H - 37
8958N.05.10	132705	H - 37
8958N.05.13	132706	H - 37
8958N.06.05	132707	H - 37
8958N.06.10	132708	H - 37
8958N.06.13	132709	H - 37
8958N.08.10	132710	H - 37
8958N.08.13	132711	H - 37

CODE	ID	PAGE
8963N.03.05	138379	H - 38
8963N.04.05	132712	H - 38
8963N.04.10	132713	H - 38
8963N.05.05	132714	H - 38
8963N.05.10	132715	H - 38
8963N.05.13	132716	H - 38
8963N.06.05	132717	H - 38
8963N.06.10	132718	H - 38
8963N.06.13	132719	H - 38
8963N.08.10	132720	H - 38
8963N.08.13	132721	H - 38
8968N.0305	138380	H - 37
8968N.0405	132722	H - 37
8968N.0410	132723	H - 37
8968N.0505	132724	H - 37
8968N.0510	132725	H - 37
8968N.0513	132726	H - 37
8968N.0605	132727	H - 37
8968N.0610	132728	H - 37
8968N.0613	132729	H - 37
8968N.0810	132730	H - 37
8968N.0813	132731	H - 37
8973N.03.05	138381	H - 38
8973N.04.05	132732	H - 38
8973N.04.10	132733	H - 38
8973N.05.05	132734	H - 38
8973N.05.10	132735	H - 38
8973N.05.13	132736	H - 38
8973N.06.05	132737	H - 38
8973N.06.10	132738	H - 38
8973N.06.13	132739	H - 38
8973N.08.10	132740	H - 38
8973N.08.13	132741	H - 38
8978N.0305	138382	H - 37
8978N.0405	132742	H - 37
8978N.0410	132743	H - 37
8978N.0505	132744	H - 37
8978N.0510	132745	H - 37
8978N.0513	132746	H - 37
8978N.0605	132747	H - 37
8978N.0610	132748	H - 37
8978N.0613	132749	H - 37
8978N.0810	132750	H - 37
8978N.0813	132751	H - 37
AVP25T	132084	H - 30
AVP345T	132086	H - 30
AVP35T	132085	H - 30
AVP45T	132087	H - 30
BS02	132088	H - 11
BS03	132089	H - 11
BS04	132090	H - 11
C400200130	132122	H - 32
C400200131	132123	H - 32
C400500001	-	H - 31
C400600001	-	H - 31
C400700001	150778	H - 31
C500500001	-	H - 31
C500600001	133376	H - 31
C750500001	-	H - 31
C750600001	133378	H - 31
C950500001	138791	H - 31
C950600001	133389	H - 31

Part No. Index

CODE	ID	PAGE
CAP1	132091	H - 38
CX150	132118	H - 31
CX25	132119	H - 31
CX50	132120	H - 31
DB02	132128	H - 11
DB03	132129	H - 11
DB04	132130	H - 11
DB08	132131	H - 11
DSN02M	133494	H - 36
DSN02W	132133	H - 36
DSN03M	133495	H - 36
DSN04	133496	H - 36
DSN04M	133497	H - 36
DSN04W	132135	H - 36
DSN05M	133499	H - 36
DSN08	133500	H - 36
DSN08M	133501	H - 36
DSN08W	132137	H - 36
F10STP	132158	H - 22
F2STP	132159	H - 22
F3STP	132160	H - 22
F4STP	132162	H - 22
FR10STP	132151	H - 27
FR2STP	132152	H - 27
FR3STP	132153	H - 27
FR4STP	132155	H - 27
FRL102STP	132140	H - 26
FRL10STP	132139	H - 25
FRL22STP	132142	H - 26
FRL2STP	132141	H - 25
FRL32STP	132144	H - 26
FRL3STP	132143	H - 25
FRL42STP	132149	H - 26
FRL4STP	132147	H - 25
L10STP	132187	H - 24
L2STP	132188	H - 24
L3STP	132189	H - 24
L4STP	132191	H - 24
M4F806	134812	H - 32
M4F812	132207	H - 32
M4P806	134815	H - 32
M4P806W	134816	H - 32
M4P812	134817	H - 32
M4P812W	132208	H - 32
M5F806	134821	H - 32
M5F812	134822	H - 32
M5P806	134823	H - 32
M5P806W	134824	H - 32
M5P812	134825	H - 32
M5P812W	132209	H - 32
M6F406	134829	H - 32
M6F412	132210	H - 32
M6P406	134830	H - 32
M6P406W	134831	H - 32
M6P412	134832	H - 32
M6P412W	134833	H - 32
MR114ST	132201	H - 31
MR114ST4	132203	H - 31
MR114STRFA	132202	H - 31
MR118ST	132204	H - 31
MR118ST4	132206	H - 31
MR118STRFA	132205	H - 31

CODE	ID	PAGE
PC04	132212	H - 11
PC08	132213	H - 11
PL04	132215	H - 11
PL08	132216	H - 11
PM10A	132218	H - 38
PM10C	132219	H - 38
PT01	132222	H - 46
R10ST	132306	H - 23
R2ST	132307	H - 23
R3ST	132308	H - 23
R4ST	132310	H - 23
RA02.12.12	132223	H - 8
RA02.14.12	132224	H - 8
RA02.14.14	132225	H - 8
RA02.14.38	132226	H - 8
RA02.18.14	132227	H - 8
RA02.18.18	132228	H - 8
RA02.18.38	132229	H - 8
RA02.38.12	132230	H - 8
RA02.38.38	132231	H - 8
RA03.12	132232	H - 8
RA03.14	132233	H - 8
RA03.18	132234	H - 8
RA03.38	132235	H - 8
RA04.12.14	132236	H - 10
RA04.12.38	132237	H - 10
RA04.14.18	132238	H - 10
RA04.34.12	135028	H - 10
RA04.38.14	132239	H - 10
RA04.38.18	132240	H - 10
RA05.12.12	132241	H - 10
RA05.14.14	132242	H - 10
RA05.14.38	132243	H - 10
RA05.18.14	132244	H - 10
RA05.18.18	132245	H - 10
RA05.38.12	132246	H - 10
RA05.38.38	132247	H - 10
RA06.14.12	132248	H - 8
RA06.14.38	132249	H - 8
RA06.18.14	132250	H - 8
RA06.18.38	132251	H - 8
RA06.38.12	132252	H - 8
RA07.12	132253	H - 11
RA07.14	132254	H - 11
RA07.18	132255	H - 11
RA07.38	132256	H - 11
RA08.12	135036	H - 11
RA08.14	135037	H - 11
RA08.18	135038	H - 11
RA08.38	135039	H - 11
RA09.12.12	132257	H - 8
RA09.14.14	132258	H - 8
RA09.18.18	132259	H - 8
RA09.38.38	132260	H - 8
RA10.12.12	132261	H - 8
RA10.14.14	132262	H - 8
RA10.18.18	132263	H - 8
RA10.38.38	132264	H - 8
RA11.12	132265	H - 9
RA11.14	132266	H - 9
RA11.18	132267	H - 9
RA11.38	132268	H - 9

CODE	ID	PAGE
RA12.12.12	132269	H - 9
RA12.14.14	132270	H - 9
RA12.18.18	132271	H - 9
RA12.38.38	132272	H - 9
RA13.12.12	132273	H - 9
RA13.14.14	132274	H - 9
RA13.18.18	132275	H - 9
RA13.38.38	132276	H - 9
RA15.12	132277	H - 8
RA15.14	132278	H - 8
RA15.18	132279	H - 8
RA15.38	132280	H - 8
RA16.12	132281	H - 9
RA16.14	132282	H - 9
RA16.18	132283	H - 9
RA16.38	132284	H - 9
RA17.12.12	-	H - 9
RA17.14.14	-	H - 9
RA17.18.18	135040	H - 9
RA17.38.38	-	H - 9
RA18.12.12	-	H - 9
RA18.14.14	-	H - 9
RA18.18.18	135041	H - 9
RA18.38.38	-	H - 9
RA19.07.14	132285	H - 10
RA19.07.18	132286	H - 10
RA19.09.14	132287	H - 10
RA19.09.18	132288	H - 10
RA19.09.38	132289	H - 10
RA19.12.12	132290	H - 10
RA19.12.14	132291	H - 10
RA19.12.38	132292	H - 10
RA19.17.12	132293	H - 10
RA19.17.38	132294	H - 10
RA21.12	135057	H - 10
RA21.14	135058	H - 10
RA21.18	135059	H - 10
RA21.38	135060	H - 10
RFB02	132295	H - 36
RFB03	132296	H - 36
RFB04	132297	H - 36
RFB08	132298	H - 36
RFU02	132299	H - 36
RFU03	132300	H - 36
RFU04	132301	H - 36
RFU08	132302	H - 36
RY03	132303	H - 10
RY04	132304	H - 10
RY08	132305	H - 10
S 4	-	H - 32
S 5	-	H - 32
S 6	-	H - 32
SB02	132312	H - 35
SB03	132313	H - 35
SB04	132314	H - 35
SB05	135354	H - 35
SB08	132315	H - 35
SN02	135487	H - 35
SN02P	132316	H - 35
SN03	135488	H - 35
SN03P	132317	H - 35
SN04	135489	H - 35

Part No. Index

CODE	ID	PAGE
SN04P	132318	H - 35
SN08	135490	H - 35
SN08P	132319	H - 35
SP.750.3923	170643	H - 46
SP02	132320	H - 35
SP03	132321	H - 35
SP04	132322	H - 35
SP08	132323	H - 35
SQG	132334	H - 32
SQM	132335	H - 32
SQP	132336	H - 32
SR02	132337	H - 35
SR03	132338	H - 35
SR04	132339	H - 35
SR05	169643	H - 35
SR08	132340	H - 35
TB2O	132342	H - 11
TB3O	132344	H - 11
TB4O	132346	H - 11
TB8O	132348	H - 11
V612201	132380	H - 40

CODE	ID	PAGE
V613300	132381	H - 40
V614400	132382	H - 40
V618800	132383	H - 40
V712201	132384	H - 40
V713300	132385	H - 40
V714400	132386	H - 40
V718800	132387	H - 40
VAND08	132354	H - 40
VEC2ST	132355	H - 29
VEC34ST	132357	H - 29
VEC3ST	132356	H - 29
VEC4ST	132358	H - 29
VKS02	136332	H - 39
VKS03	136334	H - 39
VKS04	136335	H - 39
VM02	132363	H - 39
VM03	132364	H - 39
VM04	132365	H - 39
VM08	132366	H - 39
VMB02	132359	H - 39
VMB03	132360	H - 39

CODE	ID	PAGE
VMB04	132361	H - 39
VMB08	132362	H - 39
VOR04	132367	H - 40
VOR08	64724	H - 40
VSB2ST	132368	H - 28
VSB34ST	132371	H - 28
VSB3ST	132370	H - 28
VSB4ST	132372	H - 28
VSR02	132373	H - 39
VSR03	136361	H - 39
VSR04	132374	H - 39
VSR08	132375	H - 39
VSR10	-	H - 39
VSR34	136362	H - 39
VU02	132376	H - 39
VU03	132377	H - 39
VU04	132378	H - 39
VU05	136368	H - 39
VU08	132379	H - 39



BSG Kuhnke Solutions S.r.l.

Via R. Colpi, 38
35010 Limena (PD) - Italy

Tel. +39 049 86 57 711
Fax +39 049 88 41 571

sales@bsgkuhnkesolutions.com
www.bsgkuhnkesolutions.com