

# Pin Header with Turned Contacts 2,54 mm

Series

104

pitch  
2,54

termination

contact size  
ø 0,76

max. pincount  
064 / 072

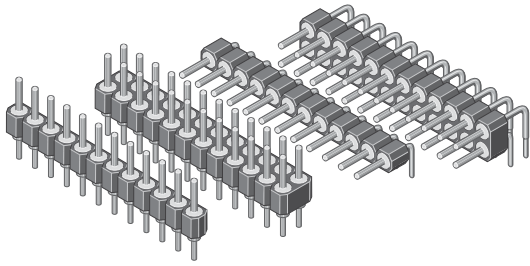

Rated current	3,0 A
Rated voltage	150 V <sub>RMS</sub> / V <sub>DC</sub>
Withstand voltage	500 V <sub>RMS</sub> for one minute
Material contact	Copper alloy
Material insulator	High temp. thermoplast UL94V-0
Operating temperature	-55°C to +125°C
Max. processing temper.	260°C for 10 seconds

All dimensions in mm.

Product group  
3

## Variation

## PCB Layout

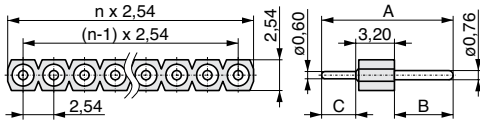

1

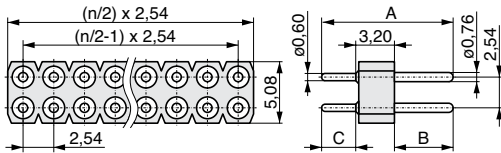
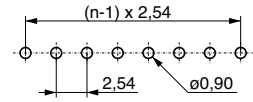

2

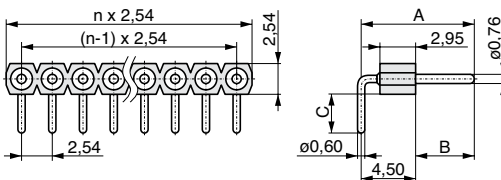
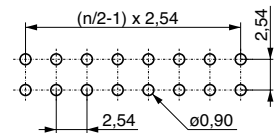

3

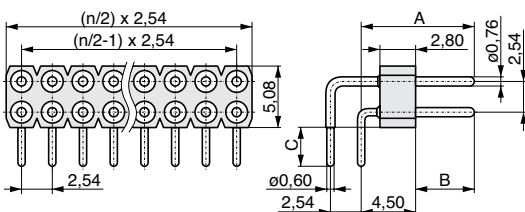
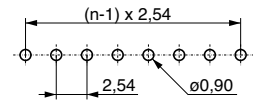

4

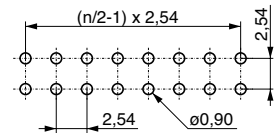

see figure left	see figure left	see figure left	available in variation			
A	B	C	1	2		
9,80	3,60	3,00	1	2		
11,05	4,85	3,00	1	2		
9,46	4,96	3,20			3	4

Plating:  
T = Sn  
F = Au

\* No. of contacts:  
Variation 1 = 002 - 064  
Variation 2 = 004 - 072  
Variation 3 = 002 - 064  
Variation 4 = 002 - 072

Variation (1,2,3,4)

No. of contacts \*  
(002... - 072)

Plating contact (T,F)

A (1/100 mm)  
e.g. 1000 = 10,00 mm



www.mpe-connector.de

Order code:

104 - 2 - 2222 - 0 - 2 - 2 - LS0 - 2222

Mating series	111	115	612	613	114	122	120
see page	4-32	4-32	4-34	4-35	4-37	4-38	4-39